



## RST GLOBAL NETWORK

**Head quarter**  
Dah keun Ind. Co., Ltd.  
Tel: +86-2-85212351  
Fax: +86-2-85218159  
Email: info@rst.com.tw  
Http://www.rst.com.tw

**USA**  
RST USA Service & Distributor  
Tel: +1(609)360-9946  
Email: sales@rstuspensionusa.com

**Europe**  
RST Europe Office  
Tel: +49-711-2588221  
Fax: +49-711-2588202  
Email: info@rst-europe.eu

**China**  
Suzhou Daxun Precision Co., Ltd.  
Tel: +86-512-86160098  
Fax: +86-512-86160100  
Email: services@rst-topway.com

RST PRODUCT SPEC 2014

Since 1972,  
RST has been bringing you the finest experience in suspension technology.

# RST

20  
14

DH/FR/AM  
XC/ATB  
XC/ASOB  
DRT JUMP  
TREKKING/CROSS  
E-BIKE

01

**CONTENT**

- 03 EVOLUTION
- 05 PRODUCT FEATURES
- 06 PRODUCT OVERVIEW
- COLORS
- STREETER OPTIONS

08

**DOWNHILL / FREERIDE / AM**

- 09 R1
- 09 STORM
- 10 TITAN
- TITAN15

12

**XC / 650B**

- 12 CHAMP 650B
- 13 FIRST 650B
- 14 AERIAL 650B
- 15 OMEGA 650B
- 16 BLAZE 650B

19

**XC / ATB**

- 19 CHAMP 29
- 20 CHAMP 29-15
- 21 CHAMP 32
- 22 CHAMP 30-15
- 23 FIRST 29
- 24 FIRST 29-15
- 25 FIRST 32
- 26 FIRST Platinum
- 27 FIRST 30
- 28 FIRST 30-15
- 29 FIRST 24
- 30 AERIAL 29 / 32
- 31 AERIAL 30 / 24
- 32 OMEGA 29 / 26
- 33 BLAZE 29 / 26
- 34 GILA / CAPA

26

**DIRT JUMP**

- 26 SPACE / DIRT

39

**CROSS TREKKING**

- 39 VOGUE
- 40 VIVAR
- 41 VITA
- 42 NEON / SOFI
- 43 NOVA / VERSE
- 44 Front light solution(PLS)
- 45 URBAN
- SINGLE SHOCK**
- 46 SS-M7 / SS-M6
- 47 SS-A7 / SS-A6
- 48 SS-A4 / SS-A2
- HYDRO-RORMING**
- 48 Hydro-R 7 / 6
- RIGID FORK**
- 50 RF-M7 / M6

52

**E-BIKE**

- 52 PULSE 650B AIR
- 53 PULSE 29 / 26 AIR
- 54 PULSE 650B
- 55 PULSE 29 / 26

57

**SPEC AND CONTACTS**

- 57 AFTER MARKET PACKAGE
- 61 SPECIFICATION
- 73 RST GLOBALLY
- 74 GLOBAL DISTRIBUTORS

**Contents**

# EVOLUTION



## 650B Advantages

- Lower rolling resistance
- Better traction than a 26" bike
- Smaller geometry limitations (a lot less than a 29er)
- Still a low center of Gravity (better than a 29er)
- Small Suspension travel limitations (a lot less than a 29er)
- Improved toe clearance compared to a 29er

## New Remote Lockout Shifter - TRL

- Complete new compact design
- 30% smaller than current SRL
- Weight reduced 20g compare to current SRL
- Easy to use with lock and unlock function
- Works with all hydraulic lockout RST forks



## Single Shock 2ND GENERATION = Comfortable SMOOTH PERFORMANCE

An elegant appearance will always be one topic for a commuting bicycle. The RST Single Shock combines the elegant appearance with a highly developed suspension system. The 2nd generation Single Shock is using an advanced Needle Bearing system that provides:

- Riding Comfort
- Smooth Performance
- Long Time Wearing Resistance
- Excellent compatibility with most of the frames on the market



## 15mm QR Through Axle Upgrade

- Based on the current RST through axle design
- Weight reduce 24% compare to current 15mm QR axle
- Improved stiffness and durable design
- Developed for aggressive off-road use
- Tool-free handling



## Lightweight Cartridge Design – "OCR-C"



OCR-Cartridge is RST's newest lightweight damping system design, based on the well-proven open bath system "OCR" Advantages of OCR-C:

1. Drastic weight loss compared to OCR
2. Easy maintenance due to the cartridge design
3. No sacrifice regarding the high OCR performance level

## Air Cartridge Design

- New air cartridge system
- No Air fork purchase needed
- Upgrade selected coil spring forks to an air spring suspension

OE model: AERIAL 30, 32, 29, 24, 650B

After market: Air cartridge upgrade kit available for

OMAGA 26, OMAGA 29, OMEGA 650B & BLAZE 26, BLAZE 650B

## Hydro Forming Project

- Fork blade produced in one piece
- Advanced Hydro Forming process
- Material: Aluminum 6061 Series

Available for:  
700C road racing & city/trekking range(700C and 26") bikes



# PRODUCT FEATURES

<b>Wheel</b>	700c Available for 700c wheel	29 Available for 29" wheel
	27.5 Available for 27.5" wheel	26 Available for 26" wheel
	24 Available for 24" wheel	20 Available for 20" wheel
<b>Material</b>	MAG Magnesium casting	ALU Aluminum casting
<b>Brake</b>	V-brake V-brake boss available	Post disc (max) Post disc mount available with recommended disc diameter
	IS disc (max) IS disc mount available with recommended disc diameter	Roller Roller brake anchor boss available (option)
<b>Accessory</b>	Carrier Front carrier mount available (option)	Dynamo Dynamo mount available
	PLS Post Lighting System	15 QR Equipped with 15mm QR axle
	Cable routing Cable routing available for hub dynamo cable	1.5" CROWN 1.5" Crown option available

OCR Platform Hydraulic Damping Control System	OCR Equipped with OCR system	OCR2 Equipped with OCR2 system
RA RA option available	AIR Equipped with AIR system	T Spring pre-load adjustment available
C Spring only, Non adjustable	TRL TRL option available	RL RL option available
TNL TNL option available	ML ML option available	TQC Equipped with TQC dropout
15 QR Equipped with 15mm QR axle	1.5" CROWN 1.5" Crown option available	

# PRODUCT OVERVIEW

	Down Hill	Free Ride	All Mountain	XC	650B	29'er	Dirt Jump	Leisure Sport	Junior	Cross	Trekking	Hydro Forming	Rear Shock	
Taman-Made Product	\$\$\$\$\$	RL		CHAMP92		CHAMP29-15								
			STORM Platform	CHAMP30-15	CHAMP 650B	CHAMP29								
			TITAN 15 Platform	FIRST 30 Platinum										
	\$\$\$\$		STORM Air	FIRST 32	FIRST 650B	FIRST 29-15	SPACE		FIRST 24	VOGUE	Single Shock HF series		ELEMENT	
			TITAN 15 Air	FIRST 30-15		FIRST 29 Air								
			TITAN Air	FIRST 30										
\$\$\$			AERIAL 32	AERIAL 650B	AERIAL 29			AERIAL 24	VIVA	Single Shock M series	Hydro-R			
			AERIAL 30							Single Shock A series	Hydro-7/6			
			OMEGA 26	OMEGA 650B	OMEGA 29					VITA				
			BLAZE 26	BLAZE 650B	BLAZE 29	DRT		CAPA 26	CAPA 24/29	NEON	VERSE	URBAN		
\$			GLA											

## COLOR OPTION

## STEERER WEIGHT

	DK-8011 SHINY BLACK (YS-728)
	DK-8010 MATT BLACK (YS-727)
	DK-0011 GLOSS WHITE (YS-701)
	DK-0012 PEARL WHITE (YS-775)
	DK-8032 GLOSS SILVER (YS-7605)

Steerer Tube	Length	Weight
Aluminum 7050	28.6mm	260mm 176g
Aluminum 7050	1.5"	260mm 205g
Aluminum 7050	1.5" Taper	260mm 186g
Hi-ten	28.6mm	260mm 326g
Hi-ten	25.4mm	260mm 290g

# DOWNHILL FREERIDE AM

Steep descents and technical terrain require top-performance from both riders and their equipment. Durable construction without a major weight penalty and high performance damping systems distinguish these forks ready for the trail, bike park, even a World Cup course.



#### ADJUSTMENT

**Platform**  
Rebound, Compression, Flow-Gate  
**Super**  
Rebound, Compression

#### STEERER

**Platform | Super**  
28.6mm 7050 Aluminum

#### SYSTEM

**Platform**  
OCR Platform(R), Coil/MCU(L)  
**Super**  
Oil(R), Coil/MCU(L)

#### STANCHION

**Platform | Super**  
36mm 7050 Aluminum Hard Anodize

#### CASTING

**Platform | Super**  
Magnesium 20mm Thru-Axle



## R1

## FOX ONE

RAPID SUSPENSION TECHNOLOGY

MODEL	Platform	Super
STEERER	28.6mm 7050 Aluminum	
CROWN PITCH	138mm-Dual	
CROWN	Aluminum Satin Black	
STANCHION	36mm 7050 Aluminum Hard Anodize	
CASTING	Magnesium 20mm Thru-Axle	
ADJUSTMENT	R, C, F	R, C
FEATURES	Platform, High/Low speed Compression, Rebound adjust	Hydraulic Compression, Rebound adjust
SYSTEM	OCR Platform(R), Coil/MCU(L)	Oil(R), Coil/MCU(L)
TRAVEL <sup>(mm)</sup>	180mm	
BRAKE TYPE	Disc Only	
WEIGHT <sup>(kg)</sup>	3.28	3.28

\*R=Rebound, C=Compression, F=Flow Gate

### STEERER

**Platform | Air**  
28.6mm 7050 Aluminum  
Super  
28.6mm Cr-mo steel

### ADJUSTMENT

**Platform**  
Air, Rebound  
Compression, Flow-Gate  
**Air**  
Air, Rebound, Compression  
**Super**  
Rebound

### SYSTEM

**Platform**  
OCR Platform(R), Air(L)  
**Air**  
Oil(R), Air(L)  
**Super**  
Oil(R), Coil/MCU(L)

### STANCHION

**Platform | Air**  
36mm 7050  
Aluminum Hard Anodize  
**Super**  
36mm Cr-mo steel Ti color

### CASTING

**Platform | Air | Super**  
Magnesium 20mm Thru-Axle



## TITAN 15

## TITAN RAPID SUSPENSION TECHNOLOGY

MODE	Platform	Air/TRL	Air
<b>STEERER</b>	28.6mm 7050 Aluminum (Optional 1.5" 7050 Aluminum steerer tube)		
<b>CROWN PITCH</b>	130mm		
<b>CROWN</b>	Aluminum Black Coating		
<b>STANCHION</b>	32mm 7050 Aluminum Hard Anodize		
<b>CASTING</b>	Magnesium 15mm QR		
<b>ADJUSTMENT</b>	A, R, C, F	A, R, RL	A, R, L, C
<b>FEATURES</b>	Platform High/Low speed Compression, Rebound adjust, Air Spring	Hydraulic Rebound adjust New Remote Lock-out, Air Spring	Hydraulic Rebound adjust Lock-out, Air Spring
<b>SYSTEM</b>	OCR Platform(R), Air(L)	Oil(R), Air(L)	
<b>TRAVEL(mm)</b>	140, 150 mm		
<b>BRAKE TYPE</b>	Disc only		
<b>WEIGHT(kg)</b> <small>(w/200mm steerer)</small>	2.19	2.16	2.14

\*A: Air, R: Rebound, C: Compression, F: Flow-Gate, RL: Remote Lock-out, L: Lock-out  
\*Steerer tube options: A: 1.5" Straight Aluminum B: 1.5" to 1 1/8 Tapered Aluminum



## STORM

## STORM RAPID SUSPENSION TECHNOLOGY

MODE	Platform	Air	Super
<b>STEERER</b>	28.6mm 7050 Aluminum (Optional 1.5" Aluminum steerer tube)		28.6mm Cr-mo steel (Optional 1.5" Aluminum steerer tube)
<b>CROWN PITCH</b>	138mm		
<b>CROWN</b>	Aluminum Black Coating		
<b>STANCHION</b>	36mm 7050 Aluminum Hard Anodize		36mm Cr-mo steel Ti color
<b>CASTING</b>	Magnesium 20mm Thru-Axle		
<b>ADJUSTMENT</b>	A, R, C, F	A, R, C	R
<b>FEATURES</b>	Platform High/Low speed Compression, Rebound adjust, Air Spring	Hydraulic Compression, Rebound adjust, Air Spring	Hydraulic Rebound adjust
<b>SYSTEM</b>	OCR Platform(R), Air(L)	Oil(R), Air(L)	Oil(R), Coil/MCU(L)
<b>TRAVEL(mm)</b>	160, 170, 180 mm		
<b>BRAKE TYPE</b>	Disc only		
<b>WEIGHT(kg)</b> <small>(w/200mm steerer)</small>	2.50	2.50	3.00

\*A: Air, R: Rebound, C: Compression, F: Flow Gate  
\*Steerer tube options: A: 1.5" Straight Aluminum B: 1.5" to 1 1/8 Tapered Aluminum



## TITAN

## TITAN RAPID SUSPENSION TECHNOLOGY

MODE	Platform	Air/TRL	Air
<b>STEERER</b>	28.6mm 7050 Aluminum (Optional 1.5" 7050 Aluminum steerer tube)		
<b>CROWN PITCH</b>	130mm		
<b>CROWN</b>	Aluminum Black Coating		
<b>STANCHION</b>	32mm 7050 Aluminum Hard Anodize		
<b>CASTING</b>	Magnesium 9mm Open Dropout		
<b>ADJUSTMENT</b>	A, R, C, F	A, R, RL	A, R, L, C
<b>FEATURES</b>	Platform High/Low speed Compression, Rebound adjust, Air Spring	Hydraulic Rebound adjust New Remote Lock-out, Air Spring	Hydraulic Rebound adjust Lock-out, Air Spring
<b>SYSTEM</b>	OCR Platform(R), Air(L)	Oil(R), Air(L)	
<b>TRAVEL(mm)</b>	140 mm		
<b>BRAKE TYPE</b>	Disc or Disc & V-brake		
<b>WEIGHT(kg)</b> <small>(w/200mm steerer)</small>	2.04	2.01	1.99

\*A: Air, R: Rebound, C: Compression, F: Flow Gate, RL: Remote Lock-out, L: Lock-out  
\*Steerer tube options: A: 1.5" Straight Aluminum B: 1.5" to 1 1/8 Tapered Aluminum



# XC / 650B

Uphill, downhill,  
this is your ticket to the fast lane...  
The introduction of the 650B standard  
gives you the real all purpose wheel  
size, and gets you back to the  
roots of Mountainbiking.



photo: Javi Filizy

**STEERER**  
650B TRL | 650B  
28.6mm 7050 Aluminum

**SYSTEM**  
650B TRL | 650B  
OCR Cartridge(R), Air(L)

**ADJUSTMENT**  
650B TRL  
Air, Rebound, Remote Lockout  
650B  
Air, Rebound, Lockout, Compression

**STANCHION**  
650B TRL | 650B  
32mm 7050  
Aluminum Hard Anodize

**CASTING**  
650B TRL | 650B  
Magnesium 9mm Open Dropout



## New CHAMP 650B CHAMP

MODEL	650B TRL	650B
STEERER	28.6mm 7050 Aluminum (Optional 1.5" 7050 Aluminum steerer tube)	
CROWN PITCH	130mm	
CROWN	Aluminum Black Coating	
STANCHION	32mm 7050 Aluminum Hard Anodize	
CASTING	Magnesium 9mm Open Dropout	
ADJUSTMENT	A, R, RL	A, R, L, C
FEATURES	Hydraulic Rebound adjust, New Remote Lock-out, Air Spring	Hydraulic Rebound adjust, Lock-out, Air Spring
SYSTEM	OCR Cartridge(R), Air(L)	
TRAVEL(mm)	80, 100, 120 mm	
BRAKE TYPE	Disc only	
WEIGHT(lb)	1.65	1.63
	(w/200mm steerer)	

\*A: Air, R: Rebound, C: Compression, RL: Remote Lock-out, L: Lock-out

\*Steerer tube options: A:1.5" Straight Aluminum B:1.5" to 1 1/8 Tapered Aluminum



## STEERER

650B TRL | 650B  
28.6mm 7050 Aluminum

## ADJUSTMENT

650B TRL  
Air, Rebound, Remote Lockout  
650B  
Air, Rebound, Lockout, Compression

## SYSTEM

650B TRL | 650B  
Oil(R), Air(L)

## STANCHION

650B TRL | 650B  
32mm 7050  
Aluminum Hard Anodize

## CASTING

650B TRL | 650B  
Magnesium 9mm Open Dropout



New

## FIRST 650B



MODLE	650B TRL	650B
STEERER	28.6mm 7050 Aluminum (Optional 1.5" 7050 Aluminum steerer tube)	
CROWN PITCH	130mm	
CROWN	Aluminum Black Coating	
STANCHION	32mm 7050 Aluminum Hard Anodize	
CASTING	Magnesium 9mm Open Dropout	
ADJUSTMENT	A, R, RL	A, R, L, C
FEATURES	Hydraulic Rebound adjust New Remote Lock-out, Air Spring	Hydraulic, Rebound adjust, Lock-out, Air Spring
SYSTEM	Oil(R), Air(L)	
TRAVEL <sub>(mm)</sub>	80, 100, 120 mm	
BRAKE TYPE	Disc only	
WEIGHT <sub>rap</sub> (w/200mm steerer)	1.96	1.94

\*A: Air, R: Rebound, C: Compression, RL: Remote Lock-out, L: Lock-out  
\*Steerer tube options: A.1.5" Straight Aluminum B.1.5" to 1 1/8 Tapered Aluminum

## STEERER

RL | TNL | ML  
28.6mm 7050 Aluminum

## ADJUSTMENT

RL  
Air, Remote Lockout  
TNL | ML  
Air, Lockout

## SYSTEM

RL | TNL  
Oil(R), Air(L)  
ML  
Air

## STANCHION

RL | TNL | ML  
32mm Steel Ti color

## CASTING

RL | TNL | ML  
Magnesium 9mm Open Dropout



New

## AERIAL 650B



MODLE	RL	TNL	ML
STEERER	28.6mm 7050 Aluminum (Optional 1.5" 7050 Aluminum steerer tube)		
CROWN PITCH	130mm		
CROWN	Aluminum Black Coating		
STANCHION	32mm Steel Ti color		
CASTING	Magnesium 9mm Open Dropout		
ADJUSTMENT	A, RL	A, L	A, L
FEATURES	Hydraulic Remote Lock-out, Air Spring	Hydraulic Lock-out, Air Spring	Mechanical Lock-out, Air Spring
SYSTEM	Oil(R), Air(L)	Oil(R), Air(L)	Air
TRAVEL <sub>(mm)</sub>	80, 100, 120 mm		
BRAKE TYPE	Disc only		
WEIGHT <sub>rap</sub> (w/200mm steerer)	2.31	2.23	2.00

\*A: Air, RL: Remote Lock-out, L: Lock-out  
\*Steerer tube options: A.1.5" Straight Aluminum B.1.5" to 1 1/8 Tapered Aluminum



**STEERER**  
RL | TNL | ML | T  
28.6mm Steel

**SYSTEM**  
RL | TNL | ML  
Oil(R), Coil(L)  
T  
Coil

**ADJUSTMENT**  
RL  
Remote Lockout, Preload  
TNL | ML  
Lockout, Preload  
T  
Preload

**STANCHION**  
RL | TNL | ML | T  
32mm Steel Ti Color

**CASTING**  
RL | TNL | ML | T  
Magnesium 9mm Open Dropout



**New**

## OMEGA 650B

MODLE	RL	TNL	ML	T
STEERER	28.6mm Steel			
CROWN PITCH	130mm			
CROWN	Aluminum ED Black			
STANCHION	32mm Steel Ti Color			
CASTING	Magnesium 9mm Open Dropout			
ADJUSTMENT	—RL, P	—L, P	—L, P	—P
	(easy preload)	(easy preload)	(easy preload)	(easy preload)
FEATURES	Hydraulic	Hydraulic	Mechanical	
	Remote Lock-out	Lock-out	Lock-out	
SYSTEM	Oil(R), Coil(L)			Coil
TRAVEL(mm)	80, 100, 120 mm			
BRAKE TYPE	Disc only			
WEIGHT(kg)	2.55	2.47	2.24	2.24
	<small>(w/200mm steerer)</small>			

\*RL:Remote Lock-out, L:Lock-out, P:Preload

**STEERER**  
RL | TNL | ML | T  
28.6mm Steel

**SYSTEM**  
RL | TNL | ML  
Oil(R), Coil(L)  
T  
Coil

**ADJUSTMENT**  
RL  
Remote Lockout, Preload  
TNL | ML  
Lockout, Preload  
T  
Preload

**STANCHION**  
RL | TNL | ML | T  
30mm Steel CP Finish

**CASTING**  
RL | TNL | ML | T  
Aluminum 9mm Open Dropout



## BLAZE 650B

MODLE	RL	TNL	ML	T
STEERER	28.6mm Steel			
CROWN PITCH	130mm			
CROWN	Aluminum ED Black			
STANCHION	30mm Steel CP Finish			
CASTING	Aluminum 9mm Open Dropout			
ADJUSTMENT	—RL, P	—L, P	—L, P	—P
	(easy preload)	(easy preload)	(easy preload)	(easy preload)
FEATURES	Hydraulic	Hydraulic	Mechanical	
	Remote Lock-out	Lock-out	Lock-out	
SYSTEM	Oil(R), Coil(L)			Coil
TRAVEL(mm)	80, 100, 120, 130 mm			
BRAKE TYPE	Disc only			
WEIGHT(kg)	2.83	2.76	2.51	2.55
	<small>(w/200mm steerer)</small>			

\*RL: Remote Lock-out, L: Lock-out, P: Preload





## XC / ATB

Lightweight and efficient suspension from 80mm to 120mm distinguish the XC and Touring lineups. Forks with a perfectly balanced mixture of comfort, performance and trail control ready for enjoying your local trail network to competing in the toughest race events.

## STEERER

29 TRL | 29  
28.6mm 7050 Aluminum

## SYSTEM

29 TRL | 29  
OCR Cartridge(R), Air(L)

## ADJUSTMENT

29 TRL | 29  
Air, Rebound, Remote Lockout  
29  
Air, Rebound, Lockout, Compression

## STANCHION

29 TRL | 29  
32mm 7050 Aluminum  
Hard Anodize

## CASTING

29 TRL | 29  
Magnesium 9mm Open Dropout



# CHAMP 29

MODEL	29 TRL	29
STEERER	28.6mm 7050 Aluminum (Optional 1.5" 7050 Aluminum steerer tube)	
CROWN PITCH	130mm	
CROWN	Aluminum Black Coating	
STANCHION	32mm 7050 Aluminum Hard Anodize	
CASTING	Magnesium 9mm Open Dropout	
ADJUSTMENT	A, R, RL	A, R, L, C
FEATURES	Hydraulic Rebound adjust New Remote Lock-out, Air Spring	Hydraulic Rebound adjust, Lock-out Air Spring
SYSTEM	OCR Cartridge(R), Air(L)	
TRAVEL (mm)	80, 100, 120 mm	
BRAKE TYPE	Disc only	
WEIGHT (kg)	1.63	1.61

\*A: Air, R: Rebound, C: Compression, RL: Remote Lock-out, L: Lock-out  
\*Steerer tube options: A: 1.5" Straight Aluminum B: 1.5" to 1 1/8" Tapered Aluminum

## STEERER

29-15 TRL | 29-15  
28.6mm 7050 Aluminum

## ADJUSTMENT

29-15 TRL  
Air, Rebound, Remote Lockout  
29-15  
Air, Rebound, Lockout, Compression

## SYSTEM

29-15 TRL | 29-15  
OCR Cartridge(R), Air(L)

## STANCHION

29-15 TRL | 29-15  
32mm 7050  
Aluminum Hard Anodize

## CASTING

29-15 TRL | 29-15  
Magnesium 15mm QR



# CHAMP 29-15

MODEL	29-15 TRL	29-15
STEERER	28.6mm 7050 Aluminum (Optional 1.5" 7050 Aluminum steerer tube)	
CROWN PITCH	130mm	
CROWN	Aluminum Black Coating	
STANCHION	32mm 7050 Aluminum Hard Anodize	
CASTING	Magnesium 15mm QR	
ADJUSTMENT	A, R, RL	A, R, L, C
FEATURES	Hydraulic Rebound adjust New Remote Lock-out, Air Spring	Hydraulic Rebound adjust Lock-out, Air Spring
SYSTEM	OCR Cartridge(R), Air(L)	
TRAVEL (mm)	80, 100, 120 mm	
BRAKE TYPE	Disc only	
WEIGHT (kg)	1.82	1.80

\*A: Air, R: Rebound, C: Compression, RL: Remote Lock-out, L: Lock-out  
\*Steerer tube options: A: 1.5" Straight Aluminum B: 1.5" to 1 1/8" Tapered Aluminum



**STEERER**  
32 TRL | 32  
28.6mm 7050 Aluminum

**ADJUSTMENT**  
32 TRL  
Air, Rebound, Remote Lockout  
32  
Air, Rebound, Lockout,  
Compression

**SYSTEM**  
32 TRL | 32  
OCR Cartridge(R), Air(L)

**STANCHION**  
32 TRL | 32  
32mm 7050 Aluminum  
Hard Anodize

**CASTING**  
32 TRL | 32  
Magnesium 9mm Open Dropout



## CHAMP 32

MODEL	32 TRL	32
STEERER	28.6mm 7050 Aluminum (Optional 1.5" 7050 Aluminum steerer tube)	
CROWN PITCH	130mm	
CROWN	Aluminum Black Coating	
STANCHION	32mm 7050 Aluminum Hard Anodize	
CASTING	Magnesium 9mm Open Dropout	
ADJUSTMENT	A, R, RL	A, R, L, C
FEATURES	Hydraulic Rebound adjust New Remote Lock-out, Air Spring	Hydraulic Rebound adjust, Lock-out, Air Spring
SYSTEM	OCR Cartridge(R), Air(L)	
TRAVEL <sup>(mm)</sup>	80, 100, 120 mm	
BRAKE TYPE	Disc only	
WEIGHT <sup>(g)</sup> <small>(w/200mm steerer)</small>	1.53	1.51

\*A: Air, R: Rebound, C: Compression, RL: Remote Lock-out, L: Lock-out  
\*Steerer tube options: A: 1.5" Straight Aluminum B: 1.5" to 1 1/8" Tapered Aluminum

**STEERER**  
30-15 TRL | 30-15  
28.6mm 7050 Aluminum

**ADJUSTMENT**  
30-15 TRL  
Air, Rebound, Remote Lockout  
30-15  
Air, Rebound, Lockout, Compression

**SYSTEM**  
30-15 TRL | 30-15  
OCR Cartridge(R), Air(L)

**STANCHION**  
30-15 TRL | 30-15  
30mm 7050  
Aluminum Hard Anodize

**CASTING**  
30-15 TRL | 30-15  
Magnesium 15mm QR



## CHAMP 30-15

MODEL	30-15 TRL	30-15
STEERER	28.6mm 7050 Aluminum (Optional 1.5" 7050 Aluminum steerer tube)	
CROWN PITCH	130mm	
CROWN	Aluminum Black Coating	
STANCHION	30mm 7050 Aluminum Hard Anodize	
CASTING	Magnesium 15mm QR	
ADJUSTMENT	A, R, RL	A, R, L, C
FEATURES	Hydraulic Rebound adjust New Remote Lock-out, Air Spring	Hydraulic Rebound adjust Lock-out, Air Spring
SYSTEM	OCR Cartridge(R), Air(L)	
TRAVEL <sup>(mm)</sup>	80, 100, 120 mm	
BRAKE TYPE	Disc only	
WEIGHT <sup>(g)</sup> <small>(w/200mm steerer)</small>	1.65	1.63

\*A: Air, R: Rebound, C: Compression, RL: Remote Lock-out, L: Lock-out  
\*Steerer tube options: A: 1.5" Straight Aluminum B: 1.5" to 1 1/8" Tapered Aluminum



## STEERER

29 TRL | 29  
28.6mm 7050 Aluminum

## SYSTEM

29 TRL | 29  
Oil(R), Air(L)

## ADJUSTMENT

29 TRL  
Air, Rebound, Remote Lockout  
29  
Air, Rebound, Lockout, Compression

## STANCHION

29 TRL | 29  
32mm 7050 Aluminum  
Hard Anodize

## CASTING

29 TRL | 29  
Magnesium 9mm Open Dropout



## FIRST 29

MODEL	29 TRL	29
STEERER	28.6mm 7050 Aluminum (Optional 1.5" 7050 Aluminum steerer tube)	
CROWN PITCH	130mm	
CROWN	Aluminum Black Coating	
STANCHION	32mm 7050 Aluminum Hard Anodize	
CASTING	Magnesium 9mm Open Dropout	
ADJUSTMENT	A, R, RL	A, R, L, C
FEATURES	Hydraulic Rebound adjust New Remote Lock-out, Air Spring	Hydraulic Rebound adjust Lock-out, Air Spring
SYSTEM	Oil(R), Air(L)	
TRAVEL(mm)	80, 100, 120 mm	
BRAKE TYPE	Disc only	
WEIGHT(g)	1.96	1.94
	(w/200mm steerer)	

\*A: Air, R: Rebound, C: Compression, RL: Remote Lock-out, L: Lock-out  
\*Steerer tube options: A 1.5" Straight Aluminum B 1.5" to 1 1/8 Tapered Aluminum

## STEERER

29-15 TRL | 29-15  
28.6mm 7050 Aluminum

## ADJUSTMENT

29-15 TRL  
Air, Rebound, Remote Lockout  
29-15  
Air, Rebound, Lockout, Compression

## SYSTEM

29-15 TRL | 29-15  
Oil(R), Air(L)

## STANCHION

29-15 TRL | 29-15  
32mm 7050  
Aluminum Hard Anodize

## CASTING

29-15 TRL | 29-15  
Magnesium 15mm QR



## FIRST 29-15

MODEL	29-15 TRL	29-15
STEERER	28.6mm 7050 Aluminum (Optional 1.5" 7050 Aluminum steerer tube)	
CROWN PITCH	130mm	
CROWN	Aluminum Black Coating	
STANCHION	32mm 7050 Aluminum Hard Anodize	
CASTING	Magnesium 15mm QR	
ADJUSTMENT	A, R, RL	A, R, L, C
FEATURES	Hydraulic Rebound adjust New Remote Lock-out, Air Spring	Hydraulic Rebound adjust Lock-out, Air Spring
SYSTEM	Oil(R), Air(L)	
TRAVEL(mm)	80, 100, 120 mm	
BRAKE TYPE	Disc only	
WEIGHT(g)	2.15	2.13
	(w/200mm steerer)	

\*A: Air, R: Rebound, C: Compression, RL: Remote Lock-out, L: Lock-out  
\*Steerer tube options: A 1.5" Straight Aluminum B 1.5" to 1 1/8 Tapered Aluminum

## STEERER

32 TRL | 32  
28.6mm 7050 Aluminum

## ADJUSTMENT

32 TRL  
Air, Rebound, Remote Lockout  
32  
Air, Rebound, Lockout, Compression

## SYSTEM

32 TRL | 32  
Oil(R), Air(L)

## STANCHION

32 TRL | 32  
32mm 7050 Aluminum  
Hard Anodize

## CASTING

32 TRL | 32  
Magnesium 9mm Open Dropout



## FIRST 32



MODEL	32 TRL	32
STEERER	28.6mm 7050 Aluminum (Optional 1.5" 7050 Aluminum steerer tube)	
CROWN PITCH	130mm	
CROWN	Aluminum Black Coating	
STANCHION	32mm 7050 Aluminum Hard Anodize	
CASTING	Magnesium 9mm Open Dropout	
ADJUSTMENT	A, R, RL	A, R, L, C
FEATURES	Hydraulic Rebound adjust New Remote Lock-out, Air Spring	Hydraulic Rebound adjust Lock-out, Air Spring
SYSTEM	Oil(R), Air(L)	
TRAVEL (mm)	80, 100, 120 mm	
BRAKE TYPE	Disc or Disc & V-brake	
WEIGHT (kg) (w/200mm steerer)	1.82	1.80

\*A: Air, R: Rebound, C: Compression, RL: Remote Lock-out, L: Lock-out

\*Steerer tube options: A: 1.5" Straight Aluminum B: 1.5" to 1 1/8 Tapered Aluminum

## STEERER

Platinum TRL | Platinum  
28.6mm 7050 Aluminum

## ADJUSTMENT

Platinum TRL  
Air, Rebound, Remote Lockout  
Platinum  
Air, Rebound, Lockout, Compression

## STANCHION

Platinum TRL | Platinum  
30mm 7050  
Aluminum Hard Anodize

## SYSTEM

Platinum TRL | Platinum  
Oil(R), Air(L)

## CASTING

Platinum TRL | Platinum  
Magnesium 9mm Open Dropout

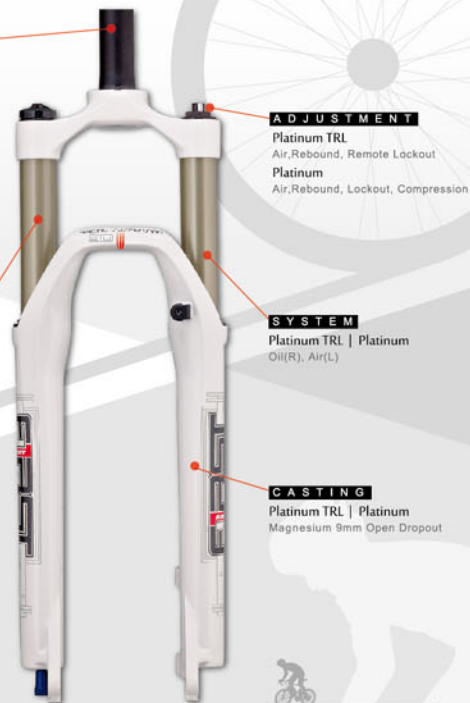

## FIRST PLATINUM



MODEL	Platinum TRL	Platinum
STEERER	28.6mm 7050 Aluminum (Optional 1.5" 7050 Aluminum steerer tube)	
CROWN PITCH	130mm	
CROWN	Aluminum Black Coating	
STANCHION	30mm 7050 Aluminum Hard Anodize	
CASTING	Magnesium 9mm Open Dropout	
ADJUSTMENT	A, R, RL	A, R, L, C
FEATURES	Hydraulic Rebound adjust New Remote Lock-out, Air Spring	Hydraulic Rebound adjust Lock-out, Air Spring
SYSTEM	Oil(R), Air(L)	
TRAVEL (mm)	80, 100 mm	
BRAKE TYPE	Disc or Disc & V-brake	
WEIGHT (kg) (w/200mm steerer)	1.52	1.50

\*A: Air, R: Rebound, C: Compression, RL: Remote Lock-out, L: Lock-out

\*Steerer tube options: A: 1.5" Straight Aluminum B: 1.5" to 1 1/8 Tapered Aluminum

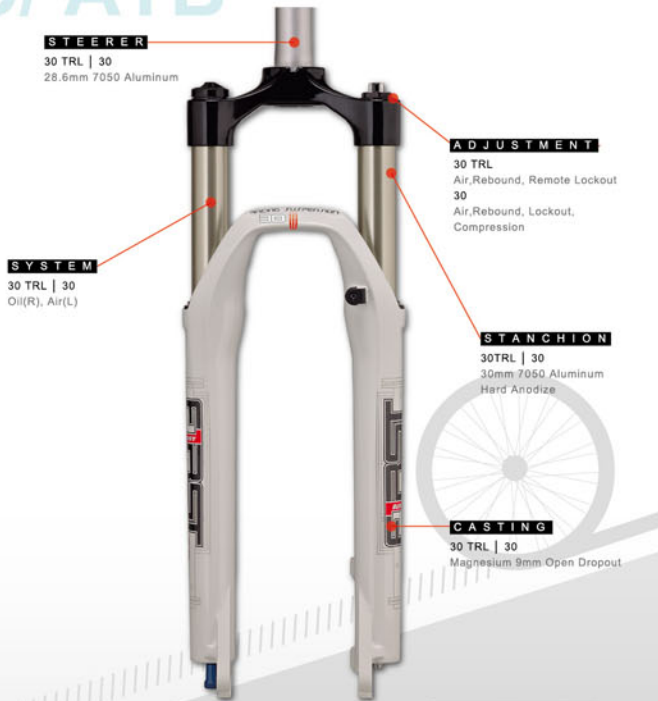

**STEERER**  
30 TRL | 30  
28.6mm 7050 Aluminum

**ADJUSTMENT**  
30 TRL  
Air, Rebound, Remote Lockout  
30  
Air, Rebound, Lockout,  
Compression

**SYSTEM**  
30 TRL | 30  
Oil(R), Air(L)

**STANCHION**  
30TRL | 30  
30mm 7050 Aluminum  
Hard Anodize

**CASTING**  
30 TRL | 30  
Magnesium 9mm Open Dropout



**STEERER**  
30-15 TRL | 30-15  
28.6mm 7050 Aluminum

**ADJUSTMENT**  
30-15 TRL  
Air, Rebound, Remote Lockout  
30-15  
Air, Rebound, Lockout, Compression

**SYSTEM**  
30-15 TRL | 30-15  
Oil(R), Air(L)

**STANCHION**  
30-15 TRL | 30-15  
30mm 7050  
Aluminum Hard Anodize

**CASTING**  
30-15 TRL | 30-15  
Magnesium 15mm QR



## FIRST 30



MODEL	30 TRL	30
STEERER	28.6mm 7050 Aluminum (Optional 1.5" 7050 Aluminum steerer tube)	
CROWN PITCH	130mm	
CROWN	Aluminum Black Coating	
STANCHION	30mm 7050 Aluminum Hard Anodize	
CASTING	Magnesium 9mm Open Dropout	
ADJUSTMENT	A, R, RL	A, R, L, C
FEATURES	Hydraulic Rebound adjust New Remote Lock-out, Air Spring	Hydraulic Rebound adjust, Lock-out, Air Spring
SYSTEM	Oil(R), Air(L)	
TRAVEL(mm)	80, 100, 120 mm	
BRAKE TYPE	Disc or Disc & V-brake	
WEIGHT(kg)	1.77	1.75

\*A: Air, R: Rebound, C: Compression, RL: Remote Lock-out, L: Lock-out  
\*Steerer tube options: A: 1.5" Straight Aluminum B: 1.5" to 1 1/8 Tapered Aluminum



## FIRST 30-15



MODEL	30-15 TRL	30-15
STEERER	28.6mm 7050 Aluminum (Optional 1.5" 7050 Aluminum steerer tube)	
CROWN PITCH	130mm	
CROWN	Aluminum Black Coating	
STANCHION	30mm 7050 Aluminum Hard Anodize	
CASTING	Magnesium 15mm QR	
ADJUSTMENT	A, R, RL	A, R, L, C
FEATURES	Hydraulic Rebound adjust New Remote Lock-out, Air Spring	Hydraulic Rebound adjust Lock-out, Air Spring
SYSTEM	Oil(R), Air(L)	
TRAVEL(mm)	80, 100, 120 mm	
BRAKE TYPE	Disc only	
WEIGHT(kg)	1.92	1.90

\*A: Air, R: Rebound, C: Compression, RL: Remote Lock-out, L: Lock-out  
\*Steerer tube options: A: 1.5" Straight Aluminum B: 1.5" to 1 1/8 Tapered Aluminum

## STEERER

24 TRL | 24  
28.6mm 7050 Aluminum

## ADJUSTMENT

24 TRL  
Air, Rebound, Remote Lockout  
24  
Air, Rebound, Lockout,  
Compression

## STANCHION

24 TRL | 24  
28.6mm 7050 Aluminum  
Hard Anodize

## CASTING

24 TRL | 24  
Magnesium 9mm Open Dropout

## SYSTEM

24 TRL | 24  
Oil(R), Air(L)



## AERIAL 29



MODEL	RL	TNL	ML
STEERER	28.6mm 7050 Aluminum (Optional 1.5" 7050 Aluminum steerer tube)		
CROWN PITCH	130mm		
CROWN	Aluminum Black Coating		
STANCHION	32mm Steel Ti Color		
CASTING	Magnesium 9mm Open Dropout		
ADJUSTMENT	A, RL	A, L	A, L
FEATURES	Hydraulic Remote Lock-out, Air Spring	Hydraulic Lock-out, Air Spring	Mechanical Lock-out, Air Spring
SYSTEM	Oil(R), Air(L)		Air
TRAVEL(mm)	80, 100, 120 mm		
BRAKE TYPE	Disc only		
WEIGHT(lbs) (w/200mm steerer)	2.36	2.28	2.05

\*A: Air, RL: Remote Lock-out, L: Lock-out

\*Steerer tube options: A: 1.5" Straight Aluminum B: 1.5" to 1 1/8 Tapered Aluminum



## FIRST 24



MODEL	24 TRL	24
STEERER	28.6mm 7050 Aluminum	
CROWN PITCH	125mm	
CROWN	Aluminum Black Coating	
STANCHION	28.6mm 7050 Aluminum Hard Anodize	
CASTING	Magnesium 9mm Open Dropout	
ADJUSTMENT	A, R, RL	A, R, L, C
FEATURES	Hydraulic Rebound adjust New Remote Lock-out, Air Spring	Hydraulic Rebound adjust Lock-out, Air Spring
SYSTEM	Oil(R), Air(L)	
TRAVEL(mm)	60 mm	
BRAKE TYPE	Disc & V-brake	
WEIGHT(lbs) (w/200mm steerer)	1.62	1.60

\*A: Air, R: Rebound, C: Compression, RL: Remote Lock-out, L: Lock-out

\*Steerer tube options: A: 1.5" Straight Aluminum B: 1.5" to 1 1/8 Tapered Aluminum



## AERIAL 32



MODEL	RL	TNL	ML
STEERER	28.6mm 7050 Aluminum (Optional 1.5" 7050 Aluminum steerer tube)		
CROWN PITCH	130mm		
CROWN	Aluminum Black Coating		
STANCHION	32mm Steel Ti Color		
CASTING	Magnesium 9mm Open Dropout		
ADJUSTMENT	A, RL	A, L	A, L
FEATURES	Hydraulic Remote Lock-out, Air Spring	Hydraulic Lock-out, Air Spring	Mechanical Lock-Out, Air Spring
SYSTEM	Oil(R), Air(L)		Air
TRAVEL(mm)	80, 100, 120 mm		
BRAKE TYPE	Disc or Disc & V-brake		
WEIGHT(lbs) (w/200mm steerer)	2.33	2.25	2.02

\*A: Air, RL: Remote Lock-out, L: Lock-out

\*Steerer tube options: A: 1.5" Straight Aluminum B: 1.5" to 1 1/8 Tapered Aluminum







## AERIAL 30



MODEL	RL	TNL	ML	T
STEERER	28.6mm 7050 Aluminum (Optional 1.5" 7050 Aluminum steerer tube)			
CROWN PITCH	130mm			
CROWN	Aluminum Black Coating			
STANCHION	30mm Steel Ti Color			
CASTING	Magnesium 9mm Open Dropout			
ADJUSTMENT	A, RL	A, L	A, L	P
FEATURES	Hydraulic Remote	Hydraulic Lock-out,	Mechanical Lock-out,	
	Lock-out, Air Spring	Air Spring	Air Spring	
SYSTEM	Oil(R), Air(L)			
TRAVEL (mm)	80, 100, 120 mm			
BRAKE TYPE	Disc or Disc & V-brake			
WEIGHT (kg)	2.22	2.15	1.89	

\*A: Air, RL: Remote Lock-out, L: Lock-out

\*Steerer tube options: A:1.5" Straight Aluminum B:1.5" to 1 1/8 Tapered Aluminum



New

## AERIAL 24



MODEL	RL	TNL	ML	T
STEERER	28.6mm 7050 Aluminum			
CROWN PITCH	125mm			
CROWN	Aluminum Black Coating			
STANCHION	28.6mm Steel Ti Color			
CASTING	Magnesium 9mm Open Dropout			
ADJUSTMENT	A, RL	A, L	A, L	P
FEATURES	Hydraulic Remote	Hydraulic Lock-out,	Mechanical Lock-out,	
	Lock-out, Air Spring	Air Spring	Air Spring	
SYSTEM	Oil(R), Air(L)			
TRAVEL (mm)	60 mm			
BRAKE TYPE	Disc & V-brake			
WEIGHT (kg)	2.01	1.93	1.73	

\*A: Air, RL: Remote Lock-out, L: Lock-out



## OMEGA 29



MODEL	RL	TNL	ML	T
STEERER	28.6mm Steel			
CROWN PITCH	130mm			
CROWN	Aluminum ED Black			
STANCHION	32mm Steel Ti Color			
CASTING	Magnesium 9mm Open Dropout			
ADJUSTMENT	RL, P	L, P	L, P	P
FEATURES	(easy preload)	(easy preload)	(easy preload)	(easy preload)
	Hydraulic	Hydraulic	Mechanical	
	Remote Lock-out	Lock-out	Lock-out	
SYSTEM	Oil(R), Coil(L)			Coil
TRAVEL (mm)	80, 100, 120 mm			
BRAKE TYPE	Disc only			
WEIGHT (kg)	2.55	2.47	2.24	2.24

\*RL: Remote Lock-out, L: Lock-out, P: Preload



## OMEGA 26



MODEL	RL	TNL	ML	T
STEERER	28.6mm Steel			
CROWN PITCH	130mm			
CROWN	Aluminum ED Black			
STANCHION	30mm Steel Ti Color			
CASTING	Magnesium 9mm Open Dropout			
ADJUSTMENT	RL, P	L, P	L, P	P
FEATURES	(easy preload)	(easy preload)	(easy preload)	(easy preload)
	Hydraulic	Hydraulic	Mechanical	
	Remote Lock-out	Lock-out	Lock-out	
SYSTEM	Oil(R), Coil(L)			Coil
TRAVEL (mm)	80, 100, 120 mm			
BRAKE TYPE	Disc or Disc & V-brake			
WEIGHT (kg)	2.44	2.37	2.11	2.11

\*RL: Remote Lock-out, L: Lock-out, P: Preload





## BLAZE 29



MODLE	RL	TNL	ML	T
STEERER	28.6mm Steel			
CROWN PITCH	130mm			
CROWN	Aluminum ED Black			
STANCHION	30mm Steel CP Finish			
CASTING	Aluminum 9mm Open Dropout			
ADJUSTMENT	RL, P	L, P	L, P	P
FEATURES	Hydraulic	Hydraulic	Mechanical	
	Remote Lock-out	Lock-out	Lock-out	
SYSTEM	Oil(R), Coil(L)			Coil
TRAVEL(mm)	80, 100, 120 mm			
BRAKE TYPE	Disc or Disc & V-brake			
WEIGHT(kg)	2.92	2.84	2.61	2.61

\*RL: Remote Lock-out, L: Lock-out, P: Preload



## GILA



MODLE	RL	TNL	ML	T
STEERER	28.6mm Steel			
CROWN PITCH	125mm			
CROWN	Aluminum ED Black			
STANCHION	28.6mm Steel CP Finish			
CASTING	Aluminum 9mm Open Dropout			
ADJUSTMENT	RL, P	L, P	L, P	P
FEATURES	Hydraulic	Hydraulic	Mechanical	
	Remote Lock-out	Lock-out	Lock-out	
SYSTEM	Oil(R), Coil(L)			Coil
TRAVEL(mm)	80, 100 mm			
BRAKE TYPE	Disc or Disc & V-brake			
WEIGHT(kg)	2.42	2.35	2.10	2.05

\*RL: Remote Lock-out, L: Lock-out, P: Preload



## BLAZE 26



MODLE	RL	TNL	ML	T
STEERER	28.6mm Steel			
CROWN PITCH	125mm			
CROWN	Aluminum ED Black			
STANCHION	30mm Steel CP Finish			
CASTING	Aluminum 9mm Open Dropout			
ADJUSTMENT	RL, P	L, P	L, P	P
FEATURES	Hydraulic	Hydraulic	Mechanical	
	Remote Lock-out	Lock-out	Lock-out	
SYSTEM	Oil(R), Coil(L)			Coil
TRAVEL(mm)	80, 100, 120 mm			
BRAKE TYPE	Disc or Disc & V-brake			
WEIGHT(kg)	2.62	2.55	2.30	2.34

\*RL: Remote Lock-out, L: Lock-out, P: Preload



## CAPA



MODLE	ML 26, 24	T26, T24, T20
STEERER	28.6/25.4mm Steel	
CROWN PITCH	120mm	
CROWN	Aluminum ED Black	
STANCHION	25.4mm Steel CP Finish	
CASTING	Aluminum 9mm Open Dropout	
ADJUSTMENT	L, P	P
FEATURES	Mechanical Lock-out	
SYSTEM	Coil	
TRAVEL(mm)	26": 80mm / 24": 50mm	26": 80mm / 24": 50mm / 20": 50mm
BRAKE TYPE	Disc & V-brake	
WEIGHT(kg)	ML26": 2.03 / ML24": 1.93	T26": 1.98 / T24": 1.84 / T20": 1.75

\*L: Lock-out, P: Preload



# DIRT JUMP

The fork series for DIRT riders. Increased durability and ready for air. Time to touch. Short travel design combined with a top performing damping system make for forks ready to take on the tough lines on the planet.



## SPACE SPACE EXPANSION TECHNOLOGY

MODEL	Jump	Free
STEERER	28.6mm 7050 Aluminum	28.6mm Cr-mo Steel
CROWN PITCH	138mm	
CROWN	Aluminum Black Coating	
STANCHION	36mm 7050 Aluminum Hard Anodize	36mm Cr-mo Steel Ti Color
CASTING	Magnesium 20mm Alloy Thru-Axle	
ADJUSTMENT	A, R	R
FEATURES	Hydraulic Rebound adjust, Air Spring	Hydraulic Rebound adjust
SYSTEM	Oil(R), Air(L)	Oil(R), Coil(MCU(L))
TRAVEL(mm)	80, 100mm	
BRAKE TYPE	Disc only	
WEIGHT(kg)	2.63 <small>(w/200mm steerer)</small>	2.93

\*A:Air, R:Rebound



## DIRT SPACE EXPANSION TECHNOLOGY

MODEL	RA	P
STEERER	28.6mm steel	
CROWN PITCH	130mm	
CROWN	Aluminum ED Black	
STANCHION	32mm Steel CP Finish	
CASTING	Aluminum 9mm Open Dropout	
ADJUSTMENT	R, P	P
FEATURES	Hydraulic Rebound adjust	Preload
SYSTEM	Oil(R), Coil(L)	Coil
TRAVEL(mm)	80, 100, 130 mm	
BRAKE TYPE	Disc or Disc & V-brake	
WEIGHT(kg)	3.01 <small>(w/200mm steerer)</small>	3.05

\*R:Rebound, P:Preload



# CROSS TREKKING

Comfortable forks for touring and city bikes with travel around 50mm.  
Efficient suspension forks that include mounting options that allow use of integrated lights, fenders, dynamos and even rollerbrake use.  
Carefree technical systems allow convenient daily use.

## Testing Standard of E-BIKE / Pedelec

Test requirement  
E-BIKE

1. Bending Fatigue test exceeding DIN-EN 14764 (4.9.6):  
620N, 100,000 cycles.
2. Emergency braking test:  
According to old DIN 79100 - force increased to 1800N.
3. The other test refer to DIN-EN 14781.
4. Test frequency 4 Hz.

Pedelec

1. Bending Fatigue test exceeding DIN-EN  
14764(4.9.6):500N, 100,000 cycles.
2. Emergency braking test: According to old  
DIN79100 - force increased to 1800N.
3. The other test refer to DIN-EN 14764.
4. Test frequency 4 Hz.

# CROSS TREKKING

## STEERER

Air TRL | Air  
28.6mm 7050 Aluminum

## ADJUSTMENT

Air TRL  
Air, Rebound, Remote Lockout  
Air  
Air, Rebound, Lockout,  
Compression

## SYSTEM

Air TRL | Air  
Oil(R), Air(L)

## STANCHION

Air TRL | Air  
28.6mm 7050 Aluminum  
Hard Anodize

## CASTING

Air TRL | Air  
Magnesium 9mm Open Dropout



## VOGUE

## VOGUE

MODLE	Air TRL	Air
STEERER	28.6mm 7050 Aluminum	
CROWN PITCH	112mm	
CROWN	Aluminum Black Coating	
STANCHION	28.6mm 7050 Aluminum Hard Anodize	
CASTING	Magnesium 9mm Open Dropout	
ADJUSTMENT	A, R, RL	A, R, L, C
FEATURES	Hydraulic Rebound adjust New Remote Lock-out, Air Spring	Hydraulic Rebound adjust Lock-out, Air Spring
SYSTEM	Oil(R), Air(L)	
TRAVEL(mm)	700C : 50, 60, 75 mm	
BRAKE TYPE	Disc or Disc & V-brake	
WEIGHT(kg) (w/200mm steerer)	1.65	1.63

**Suitable for : Pedelec Only**

\*A: Air, R: Rebound, C: Compression, RL: Remote Lock-out, L: Lock-out

## STEERER

RL | TNL | ML  
28.6mm 7050 Aluminum

## ADJUSTMENT

RL  
Air, Remote Lockout  
TNL | ML  
Air, Lockout

## SYSTEM

RL | TNL | ML  
Oil(R), Air(L)

## STANCHION

RL | TNL | ML  
28.6mm Steel Ti Color

## CASTING

RL | TNL | ML  
Magnesium 9mm Open Dropout



## New VIVAir

## VIVAIR

MODLE	RL	TNL	ML
STEERER	28.6mm 7050 Aluminum		
CROWN PITCH	112mm		
CROWN	Aluminum Black Coating		
STANCHION	28.6mm Steel Ti Color		
CASTING	Magnesium 9mm Open Dropout		
ADJUSTMENT	A, RL	A, L	A, L
FEATURES	Hydraulic Remote Lock-out, Air Spring	Hydraulic Lock-out, Air Spring	Mechanical Lock-out, Air Spring
SYSTEM	Oil(R), Air(L)		Air
TRAVEL(mm)	700C : 50, 60 mm		
BRAKE TYPE	Disc or Disc & V-brake		
WEIGHT(kg) (w/200mm steerer)	2.10	2.02	1.80

\*A: Air, RL: Remote Lock-out, L: Lock-out

# CROSS TREKKING

## STEERER

RL | TNL | ML | T  
28.6/25.4mm Steel

## ADJUSTMENT

RL  
Remote Lockout, Preload  
TNL | ML  
Lockout, Preload  
T  
Preload

## STANCHION

RL | TNL | ML | T  
28.6mm Steel Ti Color

## SYSTEM

RL | TNL | ML  
Oil(R), Coil(L)  
T  
Coil

## CASTING

RL | TNL | ML | T  
Magnesium 9mm Open Dropout



## NEON

RST NEON



MODLE	RL	ML	T
STEERER	28.6/25.4mm Steel		
CROWN PITCH	112mm		
CROWN	Aluminum ED Black		
STANCHION	25.4mm Steel CP Finish		
CASTING	Aluminum 9mm Open Dropout		
ADJUSTMENT	RL, P	L, P	P
FEATURES	Hydraulic Remote Lock-out	Mechanical Lock-out	
SYSTEM	Oil(R), Coil(L)		Coil
TRAVEL(mm)	700C : 50, 60 mm / 26" : 75 mm		
BRAKE TYPE	Disc & V-brake		
WEIGHT(kg)	2.19	1.95	1.94

\*RL: Remote Lock-out, L: Lock-out, P: Preload



## SOFI

RST SOFI

MODLE	RL	ML	T
STEERER	28.6/25.4mm Steel		
CROWN PITCH	112mm		
CROWN	Aluminum ED Black		
STANCHION	25.4mm Steel CP Finish		
CASTING	Aluminum 9mm Open Dropout		
ADJUSTMENT	RL, P	L, P	P
FEATURES	Hydraulic Remote Lock-out	Mechanical Lock-Out	
SYSTEM	Oil(R), Coil(L)		Coil
TRAVEL(mm)	700C : 40, 50 mm / 26" : 50 mm		
BRAKE TYPE	V-brake only		
WEIGHT(kg)	2.32	2.06	2.07

Suitable for : Pedelec Only

\*RL: Remote Lock-out, L: Lock-out, P: Preload

## VITA

RST UITA

MODLE	RL	TNL	ML	T
STEERER	28.6/25.4mm Steel			
CROWN PITCH	112mm			
CROWN	Aluminum ED Black			
STANCHION	28.6mm Steel Ti Color			
CASTING	Magnesium 9mm Open Dropout			
ADJUSTMENT	RL, P (easy preload)	L, P (easy preload)	L, P (easy preload)	P (easy preload)
FEATURES	Hydraulic Remote Lock-out	Hydraulic Lock-out	Mechanical Lock-out	
SYSTEM	Oil(R), Coil(L)			Coil
TRAVEL(mm)	700C : 50, 60 mm			
BRAKE TYPE	Disc or Disc & V-brake			
WEIGHT(kg)	2.28	2.20	1.98	1.98

Suitable for : Pedelec Only

\*RL: Remote Lock-out, L: Lock-out, P: Preload





## NOVA



MODLE	RL	ML	T
STEERER	28.6/25.4mm Steel		
CROWN PITCH	112mm		
CROWN	Aluminum ED Black		
STANCHION	28.6mm Steel CP Finish		
CASTING	Aluminum 9mm Open Dropout		
ADJUSTMENT	RL, P	L, P	P
FEATURES	Hydraulic Remote Lock-out		Mechanical Lock-out
SYSTEM	Oil(R), Coil(L)		Coil
TRAVEL(mm)	700C : 50, 60 mm		
BRAKE TYPE	Disc or Disc & V-brake		
WEIGHT(kg)	2.59	2.30	2.31

Suitable for : E-BIKE and Pedelec

\*RL: Remote Lock-out, L: Lock-out, P: Preload



## VERSE

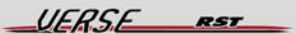

MODLE	RL	ML	T
STEERER	28.6/25.4mm Steel		
CROWN PITCH	112mm		
CROWN	Aluminum ED Black		
STANCHION	28.6mm Steel CP Finish		
CASTING	Aluminum 9mm Open Dropout		
ADJUSTMENT	RL, P	L, P	P
FEATURES	Hydraulic Remote Lock-out		Mechanical Lock-out
SYSTEM	Oil(R), Coil(L)		Coil
TRAVEL(mm)	700C : 40, 50 mm		
BRAKE TYPE	V-brake only		
WEIGHT(kg)	2.59	2.30	2.31

Suitable for : E-BIKE and Pedelec

\*RL: Remote Lock-out, L: Lock-out, P: Preload



## Front Light Soution



PLS-Front



PLS-Back

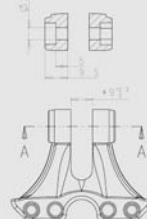

#MSGACC0921 (M5\*1.0)

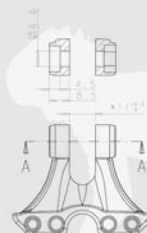

#MSGACC0920 (M6\*1.0)

#MSGACC0921 for TRELOCK and BASTA using.; #MSGACC0920 for BUMM using

## Post Lighting System Info.



Front Light Maker	RST bracket part #	Available model
— BUMM	— MSGACC0920 (using M6 Screw)	— LUMOTEC Classic — LUMOTEC L4 B — LUMOTEC LYT — LUMOTEC IQ Fly (T) — LUMOTEC IQ Cyo (T) — LUMOTEC rund — LUMOTEC Retro — LUMOTEC oval
— BASTA	— MSGACC0921 (using M5 Screw)	— Sprint
— TRELOCK	— MSGACC0921 (using M5 Screw)	— LS 850 series / LS 870 series — Bird series

## STEERER

RL | ML | T  
28.6/25.4mm Steel

## SYSTEM

RL | ML  
Oil(R), Coil(L)  
T  
Coil

## STANCHION

RL | ML | T  
25.4mm Steel CP Finish

## ADJUSTMENT

RL  
Remote Lockout, Preload  
ML  
Lockout, Preload  
T  
Preload

## CASTING

RL | ML | T  
Aluminum 9mm Open Dropout



## URBAN



MODLE	RL	ML	T
STEERER	28.6/25.4mm Steel		
CROWN PITCH	112mm		
CROWN	Aluminum ED Black		
STANCHION	25.4mm Steel CP Finish		
CASTING	Aluminum 9mm Open Dropout		
ADJUSTMENT	RL, P	L, P	P
FEATURES	Hydraulic Remote Lock-out	Mechanical Lock-out	
SYSTEM	Oil(R), Coil(L)		Coil
TRAVEL(mm)	700C : 40 mm		
BRAKE TYPE	Roller & Disc brake only, No V-brake available		
WEIGHT(kg)	2.15	1.86	1.87

\*RL: Remote Lock-out, L: Lock-out, P: Preload

## SINGLE SHOCK-M series

### SS-M7 T/ SS-M7



MODLE	SS-M7T	SS-M7
WHEEL SIZE	700C	
TRAVEL(mm)	30mm	35mm
FEATURES	Mag. Blade, Spring Preload	Mag. Blade
STEERER	28.6mm 7050 Aluminum (Min. length: 200mm)	
LOWER	Magnesium 9mm Open Dropout	
BRAKE TYPE	Disc + V-brake (Optional Roller Mount)	
WEIGHT(kg)	1.33	1.33

SS-M7 T



SS-M6

### SS-M6 T/ SS-M6



MODLE	SS-M6 T	SS-M6
WHEEL SIZE	26"	
TRAVEL(mm)	30mm	35mm
FEATURES	Mag. Blade, Spring Preload	Mag. Blade
STEERER	28.6mm 7050 Aluminum (Min. length: 200mm)	
LOWER	Magnesium 9mm Open Dropout	
BRAKE TYPE	Disc + V-brake	
WEIGHT(kg)	1.18	1.18





# CROSS TREKKING

## SINGLE SHOCK-A series



### SS-A7 T/ SS-A7

MODLE	SS-A7 T	SS-A7
WHEEL SIZE	700C	
TRAVEL(mm)	30mm	35mm
FEATURES	Alu. Blade Spring Preload	Alu. Blade
STEERER	28.6mm 7050 Aluminum (Min. length: 200mm)	
LOWER	Aluminum 9mm Open Dropout	
BRAKE TYPE	Disc or Disc + V-brake (Optional Roller Mount)	
WEIGHT(kg)	1.60	1.60
	(w/200mm steerer)	

**SS-A7 T / SS-A7 suitable for: E-Bike and Pedelec**



SS-A7 T



SS-A6



### SS-A6 T/ SS-A6

MODLE	SS-A6 T	SS-A6
WHEEL SIZE	26"	
TRAVEL(mm)	30mm	35mm
FEATURES	Alu. Blade Spring Preload	Alu. Blade
STEERER	28.6mm 7050 Aluminum (Min. length: 200mm)	
LOWER	Aluminum 9mm Open Dropout	
BRAKE TYPE	Disc or Disc + V-brake (Optional Roller Mount)	
WEIGHT(kg)	1.52	1.52
	(w/200mm steerer)	

**SS-A6 suitable for : E-BIKE and Pedelec**  
**SS-A6 T suitable for : Pedelec only**



SS-A2-100



### SS-A2-100/ SS-A2-75

MODLE	SS-A2-100	SS-A2-75
WHEEL SIZE	20"	
TRAVEL(mm)	30mm	30mm
FEATURES	Alu. Blade (Straight)	Alu. Blade (Curve)
STEERER	28.6mm 7050 Aluminum (Min. Length: 200mm)	
LOWER	Aluminum 9mm Open Dropout	
BRAKE TYPE	Disc + V-brake	V-brake only
WEIGHT(kg)	1.32	1.28
	(w/200mm steerer)	

**SS-A2-100/SS-A2-75 suitable for: E-Bike and Pedelec**

### SS-A4 T/ SS-A4

MODLE	SS-A4 T	SS-A4
WHEEL SIZE	24"	
TRAVEL(mm)	30mm	30mm
FEATURES	Alu. Blade Spring Preload	Alu. Blade
STEERER	28.6mm 7050 Aluminum (Min. Length: 200mm)	
LOWER	Aluminum 9mm Open Dropout	
BRAKE TYPE	Disc + V-brake	
WEIGHT(kg)	1.45	1.45
	(w/200mm steerer)	

**SS-A4 suitable for: E-Bike and Pedelec**  
**SS-A4 T suitable for : Pedelec only**

SS-A4 T



## HYDRO-R



MODEL	HYDRO-R
WHEEL SIZE	700C
FEATURES	Alu. Blade
STEERER	28.6mm A-7050 Aluminum
LOWER	Aluminum 9mm Open Dropout
BRAKE TYPE	Caliper-brake
WEIGHT(kg)	0.55
	(w/200mm steerer)



## HYDRO-7/6



MODEL	HYDRO-7	HYDRO-6
WHEEL SIZE	700C	26"
FEATURES	Alu. Blade	
STEERER	28.6mm A-7050 Aluminum	
LOWER	Aluminum 9mm Open Dropout	
BRAKE TYPE	Optional (V-brake or Disc-brake)	
WEIGHT(kg)	0.65	0.60
	(w/200mm steerer)	

## RIGID FORKS RF-M7/6



MODEL	RF-M7	RF-M6
WHEEL SIZE	700C	26"
TRAVEL(mm)	N/A	
FEATURES	Mag. Blade	
STEERER	28.6 mm 7050 Aluminum	
LOWER	Magnesium 9mm Open Dropout	
BRAKE TYPE	Disc + V-brake (Optional Roller Mount)	
WEIGHT(kg)	0.83	0.75
	(w/200mm steerer)	



RF-M7



## ELEMENT



MODEL	ELEMENT LO
BODY/FINISH	Alloy, Hard Anodized in Black
SPRING	Air
DAMPING	Hydraulic Damping
EYE TO EYE / TRAVEL(mm)	150x25, 160x35, 190x45, 200x50
BOLT DIAMETER	8mm or 6mm
WEIGHT(kg)	215g(150mm) / 225g(165mm) / 245g(190mm) / 255g(200mm)
	(w/200mm steerer)

## E-Bike

Motor assisted E-bikes will change our traditional image of a bicycle regarding commuting, travelling, even vacation. They will bring us to work, lift us to the nicest sport on the high mountains.

Our new Pulse series will be the perfect product for all those tasks.



E-Bike Tour unterhalb von Schloss Neuschwanstein bei Füssen im Allgäu.

**New**

**PULSE 650B Air**

**PULSE**

	650B Air-RL	650B Air-TNL
MODEL	650B Air-RL	650B Air-TNL
STEERER	28.6mm Steel	
CROWN PITCH	130mm	
CROWN	Aluminum ED Black	
STANCHION	30mm Steel Ti Color	
CASTING	Aluminum 9mm Open Dropout	
ADJUSTMENT	A, RL	A, L
FEATURES	Hydraulic Remote Lock-out, Air Spring	Hydraulic Lock-out, Air Spring
SYSTEM	Oil(R), Air(L)	
TRAVEL(mm)	50 mm	
BRAKE TYPE	Disc Only	
WEIGHT(kg)	2.82	2.75
	(w/200mm steerer)	

\*RL: Remote Lock-out, L: Lock-out, P: Preload  
 \*Reflector is available from Bumm Model No. 306 KEB  
 \*With Standard Fender Mount Bracket



**STEERER**  
 Air-RL | Air-TNL  
 28.6mm Steel

**ADJUSTMENT**  
 Air-RL  
 Remote Lockout  
 Air-TNL  
 Lockout

**STANCHION**  
 Air-RL | Air-TNL  
 30mm Steel Ti Color

**CASTING**  
 Air-RL | Air-TNL  
 Aluminum 9mm Open Dropout

**SYSTEM**  
 Air-RL | Air-TNL  
 Oil(R), Air(L)

**Air**



**PULSE 650B Air**

**PULSE**

## New PULSE 29 Air

MODEL	29 Air-RL	29 Air-TNL
STEERER	28.6mm Steel	
CROWN PITCH	130mm	
CROWN	Aluminum ED Black	
STANCHION	30mm Steel Ti Color	
CASTING	Aluminum 9mm Open Dropout	
ADJUSTMENT	A, RL	A, L
FEATURES	Hydraulic Remote Lock-out, Air Spring	Hydraulic Lock-out, Air Spring
SYSTEM	Oil(R), Air(L)	
TRAVEL(mm)	50 mm	
BRAKE TYPE	Disc or Disc & V-brake	
WEIGHT(kg)	2.91	2.83

\*RL: Remote Lock-out, L: Lock-out, P: Preload  
 \*Reflector is available from Bumm Model No. 306 KEB  
 \*With Standard Fender Mount Bracket



**STEERER**  
 RL | TNL  
 28.6mm Steel

**ADJUSTMENT**  
 RL  
 Remote Lockout  
 TNL  
 Lockout

**SYSTEM**  
 RL | TNL  
 Oil(R), Coil(L)

**STANCHION**  
 RL | TNL  
 30mm Steel Ti Color

**CASTING**  
 RL | TNL  
 Aluminum 9mm Open Dropout



## New PULSE 26 Air

MODEL	26 Air-RL	26 Air-TNL
STEERER	28.6mm Steel	
CROWN PITCH	125mm	
CROWN	Aluminum ED Black	
STANCHION	30mm Steel Ti Color	
CASTING	Aluminum 9mm Open Dropout	
ADJUSTMENT	A, RL	A, L
FEATURES	Hydraulic Remote Lock-out, Air Spring	Hydraulic Lock-out, Air Spring
SYSTEM	Oil(R), Air(L)	
TRAVEL(mm)	50 mm	
BRAKE TYPE	Disc or Disc & V-brake	
WEIGHT(kg)	2.61	2.54

\*RL: Remote Lock-out, L: Lock-out, P: Preload  
 \*Reflector is available from Bumm Model No. 306 KEB  
 \*With Standard Fender Mount Bracket



## New PULSE 650B

MODEL	650B RL	650B TNL
STEERER	28.6mm Steel	
CROWN PITCH	130mm	
CROWN	Aluminum ED Black	
STANCHION	30mm Steel Ti Color	
CASTING	Aluminum 9mm Open Dropout	
ADJUSTMENT	A, RL	A, L
FEATURES	Hydraulic Remote Lock-out, Air Spring	Hydraulic Lock-out, Air Spring
SYSTEM	Oil(R), Coil(L)	
TRAVEL(mm)	50 mm	
BRAKE TYPE	Disc Only	
WEIGHT(kg)	2.83	2.76

\*RL: Remote Lock-out, L: Lock-out, P: Preload  
 \*Reflector is available from Bumm Model No. 306 KEB  
 \*With Standard Fender Mount Bracket



## New PULSE 29

MODEL	29 RL	29 TNL
STEERER	28.6mm Steel	
CROWN PITCH	130mm	
CROWN	Aluminum ED Black	
STANCHION	30mm Steel Ti Color	
CASTING	Aluminum 8mm Open Dropout	
ADJUSTMENT	RL, P	L, P
FEATURES	Hydraulic Remote Lock-out	Hydraulic Lock-out
SYSTEM	Oil(R), Coil(R)	
TRAVEL(mm)	50 mm	
BRAKE TYPE	Disc or Disc & V-brake	
WEIGHT(kg) (w/200mm wheel)	2.92	2.84

\*RL: Remote Lock-out, L: Lock-out, P: Preload  
 \*Reflector is available from Bumm Model No. 306 KEB  
 \*With Standard Fender Mount Bracket



## New PULSE 26

MODEL	26 RL	26 TNL
STEERER	28.6mm Steel	
CROWN PITCH	125mm	
CROWN	Aluminum ED Black	
STANCHION	30mm Steel Ti Color	
CASTING	Aluminum 8mm Open Dropout	
ADJUSTMENT	RL, P	L, P
FEATURES	Hydraulic Remote Lock-out	Hydraulic Lock-out
SYSTEM	Oil(R), Coil(R)	
TRAVEL(mm)	50 mm	
BRAKE TYPE	Disc or Disc & V-brake	
WEIGHT(kg) (w/200mm wheel)	2.62	2.55

\*RL: Remote Lock-out, L: Lock-out, P: Preload  
 \*Reflector is available from Bumm Model No. 306 KEB  
 \*With Standard Fender Mount Bracket



## DIMENSIONS

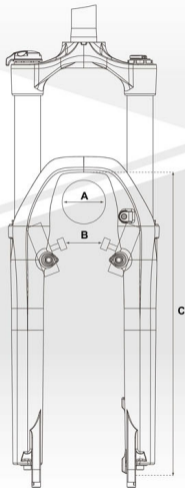

MODEL NAME	WIDTH A	WIDTH B	WIDTH C	MAXIMUM MOTOR SIZE
R 1	-69	00	350	203
STORM	-89	00	350	203
TITAN 15	-67	00	350	203
TITAN	-67	58	350	203
CHAMP 650B	-62	00	370	180
FIRST 650B	-62	00	370	180
AERIAL 650B	-62	00	370	180
OMEGA 650B	-62	00	370	180
BLAZE / PULSE 650B	-62	58	370	180
CHAMP 32	-55	58	349	180
CHAMP 30-15	-55	00	350	180
CHAMP 29-15	-69	00	390	180
CHAMP 29	-69	00	390	180
FIRST 32	-55	58	349	180
FIRST 30-15	-55	00	350	180
FIRST 30	-55	58	350	180
FIRST 24	-55	54	317	160
FIRST 26-15	-69	00	390	180
FIRST 29	-69	00	390	180
AERIAL 29	-69	00	390	180
AERIAL 30/32	-55	58	350	180
AERIAL 24	-55	54	300	180
OMEGA 29	-69	00	390	180
OMEGA 26	-55	58	350	180
BLAZE / PULSE 29	-56	63	390	180
BLAZE / PULSE 26	-59	63	350	180
GILA	-58	60	355	180
CAPA 26/24/20	-58	54	352/322/286	160
SPACE	-69	00	350	203
DIRT	-56	58	355	180
VOCLUE	-58	58	376	180
VIVAV	-58	58	376	180
VITA	-58	58	376	180
NOVA	-57	54	378	160
NEON 700/26	-57	54	582/390	160
VERSE	-57	54	378	200
SCFI 700/26	-55	50	375/355	000
URBAN	-55	00	376	160
SS-M7	-45	45	390	180
RF-M7	-45	45	390	180
SS-A7	-45	45	395	180
SS-M6	-50	45	345	160
RF-M6	-50	45	345	160
SS-A6	-50	45	345	180
SS-A4	-45	45	318	160
SS-A2-100	-32	44	295	160
SS-A2-75	-32	38	295	000
Hydro-7	-50	45	377	160
Hydro-6	-50	45	342	160
Hydro-R	-30	00	342	000

# AFTER MARKET PACKAGE



The perfect upgrade for your coil spring fork! It covers the widest possible range of riders weight and allows for custom tuning to the riders preference. In addition, it shaves some weight compared to a standard coil spring. Combine easy adjustability with the weight savings and this upgrade is a must have.

### Fitments Available For

32mm Stanchion Forks	#H5GDPCDC2012-2	OMEGA 29 / 650B, AERIAL 29 / 650B
32mm Stanchion Forks	#H5GDPCDC2012-1	AERIAL 32
30mm Stanchion Forks	#H5GDPCDC2012-3	OMEGA 26 AERIAL 26 All BLAZE series

## Air Cartridge Upgrade Kit

## High Pressure Air-Pump

RST's on inflation pump for suspension forks and rear shocks. A must have for shops, mechanics, and basically all RST Air fork riders. Dial in the perfect tune on your ride.

### Fitments Available For

Air-Pump	#H5PFGP-2200-200	All RST Air forks
----------	------------------	-------------------



Keep your suspension performing at its peak. Genuine RST grease was developed to withstand the most severe conditions. A perfectly balanced, lithium free suspension lubricant to retain that factory fresh performance of your RST fork. To be used for all suggested maintenance intervals.

### Fitments Available For

Lubrication Kit 50g	#H5GACB182	All RST models
---------------------	------------	----------------

## GREASE

## Spring Seals

Only use genuine RST seals to keep your fork performing at its peak. Spring energized lip-seals keep the dust out and the grease in. The dust seals need to be replaced when worn.

### Fitments Available For

Seals for 36mm	#H5GBH8CFC1	R1, STORM, SPACE
Seals for 32mm	#H5GBH8CEC1	TITAN, TITAN 15, CHAMP 29 / 32 / 650B, FIRST 29 / 32 / 650B
Seals for 32mm	#H5GBH8AEC1	AERIAL 29 / 32 / 650B OMEGA 29 / 650B DIRT
Seals for 30mm	#H5GBH8CCC1-1	CHAMP 30-15, FIRST 30 / PLATINUM
Seals for 30mm	#H5GBH8CDC2	OMEGA 26, BLAZE series
Seals for 28.6mm	#H5GBH8CCC1	VOGUE, VIVAir, FIRST 24
Seals for 28.6mm	#H5GBH8CCC2	GILA, VITA, NOVA, VERSE
Seals for 25.4mm	#H5GBH8CBC2	CAPA, NEON, SOFI, URBAN



# AFTER MARKET PACKAGE



(For OMEGA series only)

Genuine RST preload adjusters for replacement when something goes wrong. A wide range of adjustment, combined with high reliability, distinguish these adjusters.

#### Fitments Available For

Adjuster for 32mm	#H5GAEB29-1	DIRT
Adjuster for 32mm	#H5GAE0A29-1	OMEGA 29 / 650B
Adjuster for 30mm	#H5GAE0A30-1	OMEGA 26
Adjuster for 30mm	#H5FVP-2162-100-1	BLAZE series
Adjuster for 28.6mm	#H5FNM-2163-100-1	GILA, VITA, NOVA, VERSE
Adjuster for 25.4mm	#H5FNA-2162-100-1	CAPA, NEON, SOFI, URBAN

## Adjuster( preload)

## RST SPECIAL WRENCH

You have to have the right tools to do the job. Genuine RST preload adjusters have a unique shape that makes them stronger and you need the right tool to remove them for spring changes and fork services. One tool conveniently fits all forks past, present and future.

#### Fitments Available For

RST wrench for preload adjusters	#H5GAC616
----------------------------------	-----------

FIRST WIRELESS, OMEGA, BLAZE, GILA, CAPA, VITA, NOVA, VERSE, NEON, SOFI, URBAN



#### Fitments Available For

Cap for 32mm	#H5GAEDMG29	OMEGA 29 T, OMEGA 650B T
Cap for 30mm	#H5GAEDMG275	OMEGA 26 T, All BLAZE T series
Cap for 28.6mm	#H5GAE8MG030	GILA T, VITA T, NOVA T, VERSE T
Cap for 25.4mm	#H5FH2-2340-000	CAPA T, NEON T, SOFI T, URBAN T

## Caps

## Smart Remote Lock-out (SRL) Upgrade Kit

The SRL Upgrade moves your fork's compression adjustment and control to a more convenient location, on to your handlebar! The SRL Upgrade still allows the selection of different compression settings but also a locked-out setting at your finger tips while you ride. The SRL Upgrade Kit can be mounted on most forks with a crown mounted lock-out control.



#### Fitments Available For

SRL Upgrade Kit	#H5GDPBARL2011
-----------------	----------------

RST CHAMP FIRST, TITAN, TITAN 15, and All RST fork with TNL/RL damping

Bike Category	Down Hill			Free Ride			All Mountain			All Mountain						
	Model	PLATFORM	RT	SUPER	PLATFORM	AIR	STORM	SUPER	JUMP	SPACE	FREE	PLATFORM	AIR TRL	TITAN 15	PLATFORM	TITAN
<b>Steerer</b>		28.6mm Aluminum	28.6mm 7050 Aluminum	28.6mm 7050 C-rmo Steel	28.6mm 7050 Aluminum	28.6mm 7050 Aluminum	28.6mm 7050 Aluminum	28.6mm 7050 C-rmo Steel	28.6mm 7050 Aluminum	28.6mm 7050 Aluminum	28.6mm 7050 Aluminum	28.6mm 7050 Aluminum	28.6mm 7050 Aluminum	28.6mm 7050 Aluminum	28.6mm 7050 Aluminum	28.6mm 7050 Aluminum
<b>1.5" Steerer (Straight or Taper)</b>		—	Option	Option	Option	Option	Option	—	—	—	—	Option	Option	Option	Option	Option
<b>Crown</b>		138mm-Dual Aluminum, Satin Black	138mm Aluminum, Black Coating	138mm Aluminum, Black Coating	138mm Aluminum, Black Coating	138mm Aluminum, Black Coating	138mm Aluminum, Black Coating	138mm Aluminum, Black Coating	138mm Aluminum, Black Coating	138mm Aluminum, Black Coating	138mm Aluminum, Black Coating	130mm Aluminum, Black Coating	130mm Aluminum, Black Coating	130mm Aluminum, Black Coating	130mm Aluminum, Black Coating	130mm Aluminum, Black Coating
<b>Stanchion</b>		36mm 7050 Aluminum Hard Anodize	36mm 7050 Aluminum Hard Anodize	36mm C-rmo steel Ti color	36mm 7050 Aluminum Hard Anodize	36mm 7050 Aluminum Hard Anodize	36mm 7050 Aluminum Hard Anodize	36mm C-rmo Steel	36mm 7050 Aluminum Hard Anodize	36mm 7050 Aluminum Hard Anodize	36mm 7050 Aluminum Hard Anodize	32mm 7050 Aluminum Hard Anodize	32mm 7050 Aluminum Hard Anodize	32mm 7050 Aluminum Hard Anodize	32mm 7050 Aluminum Hard Anodize	32mm 7050 Aluminum Hard Anodize
<b>Lower</b>		Magnesium 20mm thru-Axle	Magnesium 20mm thru-Axle	Magnesium 20mm thru-Axle	Magnesium 20mm thru-Axle	Magnesium 20mm thru-Axle	Magnesium 20mm thru-Axle	Magnesium 20mm thru-Axle	Magnesium 20mm thru-Axle	Magnesium 20mm thru-Axle	Magnesium 20mm thru-Axle	Magnesium 15mm QR	Magnesium 15mm QR	Magnesium 15mm QR	Magnesium 15mm QR	Magnesium 9mm Open Dropout
<b>Feature</b>		Platform High/Low speed Compression, Rebound adjust	Platform High/Low speed Compression, Rebound adjust	Hydraulic Cartridge Rebound adjust Air Spring	Hydraulic Cartridge Rebound adjust Air Spring	Hydraulic Cartridge Rebound adjust Air Spring	Hydraulic Cartridge Rebound adjust Air Spring	Hydraulic Cartridge Rebound adjust Air Spring	Hydraulic Cartridge Rebound adjust Air Spring	Hydraulic Cartridge Rebound adjust Air Spring	Hydraulic Cartridge Rebound adjust Air Spring	High/Low speed, Compression, Rebound adjust, Air Spring	High/Low speed, Compression, Rebound adjust, Air Spring	High/Low speed, Compression, Rebound adjust, Air Spring	High/Low speed, Compression, Rebound adjust, Air Spring	High/Low speed, Compression, Rebound adjust, Air Spring
<b>Damper</b>		OCR Platform	OCR2	OCR2	OCR2	OCR2	OCR2	OCR2	OCR2	OCR2	OCR2	OCR Platform	OCR Platform	OCR Platform	OCR Platform	OCR Platform
<b>Spring</b>		Coil	Coil	Coil	Coil	Coil	Coil	Coil	Coil	Coil	Coil	Air	Air	Air	Air	Air
<b>Adjustment</b>		R, C, F	R, C	R, C	A, R, C, F	A, R, C	A, R, C	R	A, R	R	R	A, R, C, F	A, R, R, L	A, R, L, C	A, R, C, F	A, R, C, F
<b>Travel</b>		180 mm	180 mm	160, 170, 180 mm	160, 170, 180 mm	80, 100 mm	80, 100 mm	80, 100 mm	80, 100 mm	80, 100 mm	80, 100 mm	140, 150 mm	140, 150 mm	140, 150 mm	140 mm	140 mm
<b>Fork offset</b>		43mm	43mm	43mm	43mm	38mm	38mm	38mm	43mm	43mm	43mm	43mm	43mm	43mm	38mm	38mm
<b>Fork height (mm)</b>		555	555	520 / 540 / 560	520 / 540 / 560	465 / 485	465 / 485	465 / 485	465 / 485	465 / 485	465 / 485	520 / 530	520 / 530	520 / 530	520	520
<b>Brake Type</b>		Disc Only	Disc Only	Disc Only	Disc Only	Disc Only	Disc Only	Disc Only	Disc Only	Disc Only	Disc Only	Disc Only	Disc Only	Disc Only	Disc or D-V	Disc or D-V
<b>Disc Brake Mount</b>		Post	Post	Post	Post	IS	IS	IS	IS	IS	IS	Post	Post	Post	Post	Post
<b>Recommended Max. Rotor Size in mm</b>		203	203	203	203	203	203	203	203	203	203	203	203	203	203	203
<b>Dynamo Bracket Mount</b>		—	—	—	—	—	—	—	—	—	—	—	—	—	—	—
<b>Cable Guide for Hub Dynamo</b>		—	—	—	—	—	—	—	—	—	—	—	—	—	—	—
<b>Roller Brake Mount</b>		—	—	—	—	—	—	—	—	—	—	—	—	—	—	—
<b>Weight (lbs) (w/steerer at 200mm)</b>		3.28	3.28	3.28	3.00	2.80	2.80	2.83	2.63	2.63	2.83	2.19	2.16	2.14	2.04	2.04
<b>Wheel size</b>		26"	26"	26"	26"	26"	26"	26"	26"	26"	26"	26"	26"	26"	26"	26"
<b>Origin of Production</b>		Taiwan	Taiwan	Taiwan	Taiwan	Taiwan	Taiwan	Taiwan	Taiwan	Taiwan	Taiwan	Taiwan	Taiwan	Taiwan	Taiwan	Taiwan
<b>2014 VS 2013</b>		—	—	—	—	—	—	—	—	—	—	Up-grade	Up-grade	Up-grade	Up-grade	Up-grade
<b>Remarks</b>		—	—	—	—	—	—	—	—	—	—	New 15mm Axle, New Remote Lockout Lever	New 15mm Axle, New Remote Lockout Lever	New Remote Lockout Lever	New Remote Lockout Lever	New Remote Lockout Lever



# RST 2014 PRODUCT SPECIFICATION

A : Air • R : Rebound • C : Compression • F : Flow-Gate • RL : Remote Lockout • L : Lockout • P : Preload

Bike Category	All Mountain		XC 29		XC 650B		XC 26				
	TITAN		CHAMP		CHAMP		CHAMP				
<b>Model</b>	<b>AIR TRL</b>	<b>AIR</b>	<b>29 TRL</b>	<b>29-15 TRL</b>	<b>29-15 TRL</b>	<b>650B TRL</b>	<b>650B</b>	<b>32 TRL</b>	<b>32</b>	<b>30-15 TRL</b>	<b>30-15</b>
<b>Steerer</b>	28.6mm 7050 Aluminum	28.6mm 7050 Aluminum	28.6mm 7050 Aluminum	28.6mm 7050 Aluminum	28.6mm 7050 Aluminum	28.6mm 7050 Aluminum	28.6mm 7050 Aluminum	28.6mm 7050 Aluminum	28.6mm 7050 Aluminum	28.6mm 7050 Aluminum	28.6mm 7050 Aluminum
<b>1.5" Steerer (Straight or Taper)</b>	Option	Option	Option	Option	Option	Option	Option	Option	Option	Option	Option
<b>Crown</b>	130mm Aluminum, Black Coating	130mm Aluminum, Black Coating	130mm Aluminum, Black Coating	130mm Aluminum, Black Coating	130mm Aluminum, Black Coating	130mm Aluminum, Black Coating	130mm Aluminum, Black Coating	130mm Aluminum, Black Coating	130mm Aluminum, Black Coating	130mm Aluminum, Black Coating	130mm Aluminum, Black Coating
<b>Stanchion</b>	32mm 7050 Aluminum Hard Anodize	32mm 7050 Aluminum Hard Anodize	32mm 7050 Aluminum Hard Anodize	32mm 7050 Aluminum Hard Anodize	32mm 7050 Aluminum Hard Anodize	32mm 7050 Aluminum Hard Anodize	32mm 7050 Aluminum Hard Anodize	32mm 7050 Aluminum Hard Anodize	32mm 7050 Aluminum Hard Anodize	30mm 7050 Aluminum Hard Anodize	30mm 7050 Aluminum Hard Anodize
<b>Lower</b>	9mm Open Dropout	9mm Open Dropout	9mm Open Dropout	9mm Open Dropout	9mm Open Dropout	9mm Open Dropout	9mm Open Dropout	9mm Open Dropout	9mm Open Dropout	15mm QR	15mm QR
<b>Feature</b>	Hydraulic Rebound adjust, New Remote Lock-out, Air Spring	Hydraulic Compression and Rebound adjust, New Remote Lock-out, Air Spring	Hydraulic Rebound adjust, New Remote Lock-out, Air Spring	Hydraulic Compression and Rebound adjust, New Remote Lock-out, Air Spring	Hydraulic Rebound adjust, New Remote Lock-out, Air Spring	Hydraulic Compression and Rebound adjust, New Remote Lock-out, Air Spring	Hydraulic Compression and Rebound adjust, New Remote Lock-out, Air Spring	Hydraulic Rebound adjust, New Remote Lock-out, Air Spring	Hydraulic Compression and Rebound adjust, New Remote Lock-out, Air Spring	Hydraulic Compression and Rebound adjust, New Remote Lock-out, Air Spring	Hydraulic Compression and Rebound adjust, New Remote Lock-out, Air Spring
<b>Damper</b>	OCR	OCR	OCR C	OCR C	OCR C	OCR C	OCR C	OCR C	OCR C	OCR C	OCR C
<b>Spring</b>	Air	Air	Air	Air	Air	Air	Air	Air	Air	Air	Air
<b>Adjustment</b>	A, R, L	A, R, L, C	A, R, L	A, R, L, C	A, R, L, C	A, R, L, C	A, R, L, C	A, R, L, C	A, R, L, C	A, R, L, C	A, R, L, C
<b>Travel</b>	140 mm		80, 100, 120 mm		80, 100, 120 mm		80, 100, 120 mm		80, 100, 120 mm		80, 100, 120 mm
<b>Fork offset</b>	38mm		51mm		44mm		38mm		38mm		38mm
<b>Fork height (mm)</b>	520		480 / 510 / 530		475 / 485 / 515		480 / 480 / 500		480 / 480 / 500		480 / 480 / 500
<b>Brake Type</b>	Disc or D-V		Disc only		Disc only		Disc only		Disc only		Disc only
<b>Disc Brake Mount</b>	Post		Post		Post		Post		Post		Post
<b>Recommended Max. Rotor Size in mm</b>	203		180		180		180		180		180
<b>Dynamo Bracket Mount</b>	—		—		—		—		—		—
<b>Cable Guide for Hub Dynamo</b>	—		—		—		—		—		—
<b>Roller Brake Mount</b>	—		—		—		—		—		—
<b>Weight (Kgs) (w/steerer at 200mm)</b>	2.01	1.99	1.63	1.61	1.82	1.65	1.63	1.53	1.51	1.65	1.63
<b>Wheel size</b>	26"		29"		29"		27.5"		26"		26"
<b>Origin of Production</b>	Taiwan		Taiwan		Taiwan		Taiwan		Taiwan		Taiwan
<b>2014 VS 2013</b>	Up-grade		Up-grade		Up-grade		New		Up-grade		Up-grade
<b>Remarks</b>	New Remote Lockout Lever		New Decal, New Remote Lockout Lever		New Decal, New 15mm Axle, New Remote Lockout Lever		New Decal, New 15mm Axle, New Remote Lockout Lever		New Decal, New Remote Lockout Lever		New Decal, New 15mm Axle, New Remote Lockout Lever

## RST 2014 PRODUCT SPECIFICATION

Bike Category	XC 29				XC 650B				XC 26					
	29		29-15 TRL		650B TRL		650B		32 TRL		32		30 TRL	
Model	29 TRL	29-15 TRL	29-15 TRL	29-15 TRL	650B TRL	650B	650B	650B	32 TRL	32	32 TRL	32	30 TRL	FIRST
<b>Steerer</b>	28.6mm 7050 Aluminum	28.6mm 7050 Aluminum	28.6mm 7050 Aluminum	28.6mm 7050 Aluminum	28.6mm 7050 Aluminum	28.6mm 7050 Aluminum	28.6mm 7050 Aluminum	28.6mm 7050 Aluminum	28.6mm 7050 Aluminum	28.6mm 7050 Aluminum	28.6mm 7050 Aluminum	28.6mm 7050 Aluminum	28.6mm 7050 Aluminum	FIRST
<b>1.5" Steerer (Straight or Taper)</b>	Option	Option	Option	Option	Option	Option	Option	Option	Option	Option	Option	Option	Option	Option
<b>Crown</b>	130mm Aluminum, Black Coating	130mm Aluminum, Black Coating	130mm Aluminum, Black Coating	130mm Aluminum, Black Coating	130mm Aluminum, Black Coating	130mm Aluminum, Black Coating	130mm Aluminum, Black Coating	130mm Aluminum, Black Coating	130mm Aluminum, Black Coating	130mm Aluminum, Black Coating	130mm Aluminum, Black Coating	130mm Aluminum, Black Coating	130mm Aluminum, Black Coating	Option
<b>Stanchion</b>	32mm 7050 Aluminum Hard Anodize	32mm 7050 Aluminum Hard Anodize	32mm 7050 Aluminum Hard Anodize	32mm 7050 Aluminum Hard Anodize	32mm 7050 Aluminum Hard Anodize	32mm 7050 Aluminum Hard Anodize	32mm 7050 Aluminum Hard Anodize	32mm 7050 Aluminum Hard Anodize	32mm 7050 Aluminum Hard Anodize	32mm 7050 Aluminum Hard Anodize	32mm 7050 Aluminum Hard Anodize	32mm 7050 Aluminum Hard Anodize	30mm 7050 Aluminum Hard Anodize	Option
<b>Lower</b>	9mm Open Dropout Magnesium	9mm Open Dropout Magnesium	10mm QR Magnesium	10mm QR Magnesium	9mm Open Dropout Magnesium	9mm Open Dropout Magnesium	9mm Open Dropout Magnesium	9mm Open Dropout Magnesium	9mm Open Dropout Magnesium	9mm Open Dropout Magnesium	9mm Open Dropout Magnesium	9mm Open Dropout Magnesium	9mm Open Dropout Magnesium	Option
<b>Feature</b>	Hydraulic Rebound Lock-out, Air Spring	Hydraulic Rebound adjust, New Remote Lock-out, Air Spring	Hydraulic Rebound adjust, New Remote Lock-out, Air Spring	Hydraulic Rebound adjust, New Remote Lock-out, Air Spring	Hydraulic Rebound adjust, New Remote Lock-out, Air Spring	Hydraulic Rebound adjust, New Remote Lock-out, Air Spring	Hydraulic Rebound adjust, New Remote Lock-out, Air Spring	Hydraulic Rebound adjust, New Remote Lock-out, Air Spring	Hydraulic Rebound adjust, New Remote Lock-out, Air Spring	Hydraulic Rebound adjust, New Remote Lock-out, Air Spring	Hydraulic Rebound adjust, New Remote Lock-out, Air Spring	Hydraulic Rebound adjust, New Remote Lock-out, Air Spring	Hydraulic Rebound adjust, New Remote Lock-out, Air Spring	Hydraulic Rebound adjust, New Remote Lock-out, Air Spring
<b>Damper</b>	OCR	OCR	OCR	OCR	OCR	OCR	OCR	OCR	OCR	OCR	OCR	OCR	OCR	OCR
<b>Spring</b>	Air	Air	Air	Air	Air	Air	Air	Air	Air	Air	Air	Air	Air	Air
<b>Adjustment</b>	A, R, RL	A, R, L, C	A, R, RL	A, R, L, C	A, R, RL	A, R, L, C	A, R, L, C	A, R, L, C	A, R, RL	A, R, L, C	A, R, RL	A, R, L, C	A, R, L, C	A, R, RL
<b>Travel</b>		80, 100, 120 mm			80, 100, 120 mm				80, 100, 120 mm				80, 100 mm	
<b>Fork offset</b>		51mm			44mm				38mm				38mm	
<b>Fork height (mm)</b>		480 / 510 / 530			475 / 485 / 515				460 / 480 / 500				460 / 480	
<b>Brake Type</b>		Disc only			Disc only				Disc or D-V				Disc or D-V	
<b>Disc Brake Mount</b>		Post			Post				Post				Post	
<b>Recommended Max. Rotor Size in mm</b>		180			180				180				180	
<b>Dynamo Bracket Mount</b>		—			—				—				—	
<b>Cable Guide for Hub Dynamo</b>		—			—				—				—	
<b>Roller Brake Mount</b>		—			—				—				—	
<b>Weight (kgs) (w/steerer at 200mm)</b>	1.96	1.94	2.15	2.13	1.96	1.94	1.94	1.82	1.80	1.80	1.52	1.50	1.77	
<b>Wheel size</b>		29"			27.5"				26"				26"	
<b>Origin of Production</b>		Taiwan			Taiwan				Taiwan				Taiwan	
<b>2014 VS 2013</b>		Up-grade			New				Up-grade				Up-grade	
<b>Remarks</b>		New Decal, New 15mm Axle, New Remote Lock-out Lever							New Decal, New Remote Lock-out Lever				New Decal, New Remote Lock-out Lever	

# RST 2014 PRODUCT SPECIFICATION

Bike Category	XC 26			Junior XC			XC 29			XC 650B		
	FIRST	30-15 TRL	30-15	24 TRL	24	FIRST	RL	TNL	ML	RL	TNL	ML
<b>Model</b>	28.6mm 7050 Aluminum	28.6mm 7050 Aluminum	28.6mm 7050 Aluminum	28.6mm 7050 Aluminum	28.6mm 7050 Aluminum	28.6mm 7050 Aluminum	28.6mm 7050 Aluminum	28.6mm 7050 Aluminum	28.6mm 7050 Aluminum	28.6mm 7050 Aluminum	28.6mm 7050 Aluminum	28.6mm 7050 Aluminum
<b>Steerer</b>	Option	Option	Option	Option	Option	Option	Option	Option	Option	Option	Option	Option
<b>1.5" Steerer (Straight or Taper)</b>												
<b>Crown</b>	130mm Aluminum, Black Coating	130mm Aluminum, Black Coating	130mm Aluminum, Black Coating	125mm Aluminum, Black Coating	125mm Aluminum, Black Coating	130mm Aluminum, Black Coating	130mm Aluminum, Black Coating	130mm Aluminum, Black Coating	130mm Aluminum, Black Coating	130mm Aluminum, Black Coating	130mm Aluminum, Black Coating	130mm Aluminum, Black Coating
<b>Stanchion</b>	30mm 7050/Aluminum Hard Anodize	30mm 7050/Aluminum Hard Anodize	30mm 7050/Aluminum Hard Anodize	28.6mm 7050 Aluminum Hard Anodize	28.6mm 7050 Aluminum Hard Anodize	32mm steel Ti color	32mm steel Ti color	32mm steel Ti color	32mm steel Ti color	32mm steel Ti color	32mm steel Ti color	32mm steel Ti color
<b>Lower</b>	9mm Open Dropout	9mm Open Dropout	9mm Open Dropout	9mm Open Dropout	9mm Open Dropout	Magnesium	Magnesium	Magnesium	Magnesium	Magnesium	Magnesium	Magnesium
<b>Feature</b>	Mechanical Compression and Rebound adjust New Remote Lock-out, Air Spring	Mechanical Rebound adjust New Remote Lock-out, Air Spring	Mechanical Rebound adjust New Remote Lock-out, Air Spring	Hydraulic Compression and Rebound adjust New Remote Lock-out, Air Spring	Hydraulic Compression and Rebound adjust New Remote Lock-out, Air Spring	Hydraulic Rebound adjust New Remote Lock-out, Air Spring	Hydraulic Rebound adjust New Remote Lock-out, Air Spring	Hydraulic Rebound adjust New Remote Lock-out, Air Spring	Hydraulic Rebound adjust New Remote Lock-out, Air Spring	Hydraulic Rebound adjust New Remote Lock-out, Air Spring	Hydraulic Rebound adjust New Remote Lock-out, Air Spring	Hydraulic Rebound adjust New Remote Lock-out, Air Spring
<b>Damper</b>	OCR	OCR	OCR C	OCR	OCR	Hydraulic Cartridge	Hydraulic Cartridge	Hydraulic Cartridge	Hydraulic Cartridge	Hydraulic Cartridge	Hydraulic Cartridge	Hydraulic Cartridge
<b>Spring</b>	Air	Air	Air	Air	Air	Air	Air	Air	Air	Air	Air	Air
<b>Adjustment</b>	A, R, L, C	A, R, RL	A, R, L, C	A, R, RL	A, R, L, C	A, RL	A, L	A, L	A, RL	A, L	A, L	A, L
<b>Travel</b>	80, 100 mm	80, 100, 120 mm	80, 100, 120 mm	60 mm	60 mm	80, 100, 120 mm	80, 100, 120 mm	80, 100, 120 mm	80, 100, 120 mm	80, 100, 120 mm	80, 100, 120 mm	80, 100, 120 mm
<b>Fork offset</b>	39mm	39mm	39mm	39mm	39mm	51mm	51mm	51mm	44mm	44mm	44mm	44mm
<b>Fork height (mm)</b>	460 / 480	460 / 480 / 500	460 / 480 / 500	410	410	490 / 510 / 530	490 / 510 / 530	490 / 510 / 530	475 / 495 / 515	475 / 495 / 515	475 / 495 / 515	475 / 495 / 515
<b>Brake Type</b>	Disc or D+V	Disc Only	Disc Only	D+V	D+V	Disc Only	Disc Only	Disc Only	Disc Only	Disc Only	Disc Only	Disc Only
<b>Disc Brake Mount</b>	Post	Post	Post	Post	Post	Post	Post	Post	Post	Post	Post	Post
<b>Recommended Max. Rotor Size in mm</b>	180	180	180	180	180	180	180	180	180	180	180	180
<b>Dynamic Bracket Mount</b>	—	—	—	—	—	—	—	—	—	—	—	—
<b>Cable Guide for Hub Dynamo</b>	—	—	—	—	—	—	—	—	—	—	—	—
<b>Roller Brake Mount</b>	—	—	—	—	—	—	—	—	—	—	—	—
<b>Weight (Kgs) (w/steerer at 200mm)</b>	1.75	1.62	1.90	1.62	1.60	2.36	2.28	2.05	2.31	2.23	2.00	2.00
<b>Wheel size</b>	25"	25"	25"	24"	24"	25"	25"	25"	27.5"	27.5"	27.5"	27.5"
<b>Origin of Production</b>	Taiwan	Taiwan	Taiwan	Taiwan	Taiwan	Taiwan	Taiwan	Taiwan	Taiwan	Taiwan	Taiwan	Taiwan
<b>2014 VS 2013</b>	Up-grade	Up-grade	Up-grade	Up-grade	Up-grade	Up-grade	Up-grade	Up-grade	Up-grade	Up-grade	Up-grade	Up-grade
<b>Remarks</b>	New Decal New Remote Lockout Lever	New Decal New Remote Lockout Lever	New Decal New Remote Lockout Lever	New Remote Lockout Lever	New Remote Lockout Lever	New Remote Lockout Lever	New Remote Lockout Lever	New Remote Lockout Lever	Weight reduce 120g	Weight reduce 120g	Weight reduce 120g	Weight reduce 120g



# RST 2014 PRODUCT SPECIFICATION

A : Air • R : Rebound • C : Compression • F : Flow-Gate • RL : Remote Lockout • L : Lockout • P : Preload

Bike Category	XC 650B				XC				Dirt Jump			
	XC 29		OMEGA 650B		OMEGA 26		DIRT					
Model	ML	T	RL	TNL	ML	T	RL	TNL	ML	T	RA	T
<b>Steerer</b>	28.6mm Steel	28.6mm Steel	28.6mm Steel	28.6mm Steel	28.6mm Steel	28.6mm Steel	28.6mm Steel	28.6mm Steel	28.6mm Steel	28.6mm Steel	28.6mm Steel	28.6mm Steel
<b>1.5" Steerer (Straight or Taper)</b>	—	—	—	—	—	—	—	—	—	—	—	—
<b>Crown</b>	130mm Aluminum, ED Black	130mm Aluminum, ED Black	130mm Aluminum, ED Black	130mm Aluminum, ED Black	130mm Aluminum, ED Black	130mm Aluminum, ED Black	130mm Aluminum, ED Black	130mm Aluminum, ED Black	130mm Aluminum, ED Black	130mm Aluminum, ED Black	130mm Aluminum, ED Black	130mm Aluminum, ED Black
<b>Stanchion</b>	32 steel Ti color	32 steel Ti color	32mm steel Ti color	32 steel Ti color	32 steel Ti color	32 steel Ti color	30 steel Ti color	30 steel Ti color	30 steel Ti color	30 Steel Ti color	32 steel CP	32 steel CP
<b>Lower</b>	Magnesium 9mm Open Dropout	Magnesium 9mm Open Dropout	Magnesium 9mm Open Dropout	Magnesium 9mm Open Dropout	Magnesium 9mm Open Dropout	Magnesium 9mm Open Dropout	Magnesium 9mm Open Dropout	Magnesium 9mm Open Dropout	Magnesium 9mm Open Dropout	Magnesium 9mm Open Dropout	Aluminum 9mm Open Dropout	Aluminum 9mm Open Dropout
<b>Feature</b>	Mechanical Lock-Out	—	Hydraulic Remote Lock-Out	Hydraulic Lock-Out	Mechanical Lock-Out	—	Hydraulic Remote Lock-Out	Hydraulic Lock-Out	Hydraulic Lock-Out	—	Hydraulic Rebound adjust	—
<b>Damper</b>	—	—	Hydraulic Cartridge	Hydraulic Cartridge	—	—	Hydraulic Cartridge	Hydraulic Cartridge	—	—	Hydraulic Cartridge	—
<b>Spring</b>	Coil	Coil	Coil	Coil	Coil	Coil	Coil	Coil	Coil	Coil	Coil	Coil
<b>Adjustment</b>	L, P (easy preload)	P (easy preload)	RL, P (easy preload)	L, P (easy preload)	L, P (easy preload)	P (easy preload)	RL, P (easy preload)	L, P (easy preload)	L, P (easy preload)	P (easy preload)	R, P	P
<b>Travel</b>	80, 100, 120 mm	80, 100, 120 mm	80, 100, 120 mm	80, 100, 120 mm	80, 100, 120 mm	80, 100, 120 mm	80, 100, 120 mm	80, 100, 120 mm	80, 100, 120 mm	80, 100, 120 mm	80, 100, 120 mm	80, 100, 120 mm
<b>Fork offset</b>	51mm	44mm	44mm	44mm	44mm	44mm	44mm	44mm	44mm	44mm	38mm	38mm
<b>Fork height (mm)</b>	490 / 510 / 530	475 / 495 / 515	475 / 495 / 515	475 / 495 / 515	475 / 495 / 515	475 / 495 / 515	475 / 495 / 515	475 / 495 / 515	460 / 480 / 500	460 / 480 / 510	460 / 480 / 510	460 / 480 / 510
<b>Brake Type</b>	Disc Only	Disc Only	Disc Only	Disc Only	Disc Only	Disc Only	Disc Only	Disc Only	Disc or D+V	Disc or D+V	Disc or D+V	Disc or D+V
<b>Disc Brake Mount</b>	Post	Post	Post	Post	Post	Post	Post	Post	Post	Post	Post	Post
<b>Recommended Max. Rotor Size in mm</b>	180	180	180	180	180	180	180	180	180	180	180	180
<b>Dynamo Bracket Mount</b>	—	—	—	—	—	—	—	—	—	—	—	—
<b>Cable Guide for Hub Dynamo</b>	—	—	—	—	—	—	—	—	—	—	—	—
<b>Roller Brake Mount</b>	—	—	—	—	—	—	—	—	—	—	—	—
<b>Weight (kgs) (w/steerer at 200mm)</b>	2.24	2.24	2.55	2.47	2.24	2.24	2.44	2.37	2.11	2.11	3.01	3.05
<b>Wheel size</b>	29"	27.5"	27.5"	27.5"	27.5"	27.5"	27.5"	27.5"	26"	26"	26"	26"
<b>Origin of Production</b>	China	China	China	China	China	China	China	China	China	China	China	China
<b>2014 VS 2013</b>	—	New Decal	—	New	—	—	—	—	—	—	—	—
<b>Remarks</b>	—	New Decal	—	—	—	—	—	—	New Decal	—	—	—
												"130 mm travel only available with special reinforced steerer tube"



# RST 2014 PRODUCT SPECIFICATION

A : Air • R : Rebound • C : Compression • F : Flow-Gate • RL : Remote Lockout • L : Lockout • P : Preload

Bike Category	XC/Sport			Sport			Cross			Cross		
	GILA			CAPA			VOGUE			VIVA/IR		
Model	RL	TNL	ML	T	ML26, 24	T26, T24, T20	Air TRL	Air	RL	TNL	ML	Cross
<b>Steerer</b>	28.6mm Steel	28.6mm Steel	28.6mm Steel	28.6mm Steel	28.6 / 25.4mm Steel	28.6 / 25.4mm Steel	28.6mm 7050 Aluminum	28.6mm 7050 Aluminum	28.6mm 7050 Aluminum	28.6mm 7050 Aluminum	28.6mm 7050 Aluminum	28.6 / 25.4mm Steel
<b>1.5" Steerer (Straight or Taper)</b>	—	—	—	—	—	—	—	—	—	—	—	—
<b>Crown</b>	125mm Aluminum, ED Black	125mm Aluminum, ED Black	125mm Aluminum, ED Black	125mm Aluminum, ED Black	120mm Aluminum, ED Black	120mm Aluminum, ED Black	112mm Aluminum, Black Coating	112mm Aluminum, Black Coating	112mm Aluminum, Black Coating	112mm Aluminum, Black Coating	112mm Aluminum, Black Coating	112mm Aluminum, ED Black
<b>Stanchion</b>	28.6 steel CP	28.6 steel CP	28.6 steel CP	28.6 steel CP	25.4 steel CP	25.4 Steel CP	28.6mm 7050 Aluminum Hard Anodize	28.6mm 7050 Aluminum Hard Anodize	28.6 Steel Ti color	28.6 Steel Ti color	28.6 steel Ti color	28.6 steel
<b>Lower</b>	Aluminum 9mm Open Dropout	Aluminum 9mm Open Dropout	Aluminum 9mm Open Dropout	Aluminum 9mm Open Dropout	Aluminum 9mm Open Dropout	Aluminum 9mm Open Dropout	9mm Open Dropout	9mm Open Dropout	9mm Open Dropout	9mm Open Dropout	9mm Open Dropout	9mm Open Dropout
<b>Feature</b>	Hydraulic Remote Lock-Out	Hydraulic Lock-Out	Mechanical Lock-Out	—	Mechanical Lock-Out	—	Hydraulic Rebound adjust New Remote Lock-out, Air Spring	Hydraulic Compression and Rebound adjust Lock-out, Air Spring	Hydraulic Remote Lock-out, Air Spring	Hydraulic Lock-out, Air Spring	Mechanical Lock-out, Air Spring	Hydraulic Lock-Out
<b>Damper</b>	Hydraulic Cartridge	Hydraulic Cartridge	—	—	—	—	ORC	ORC	Hydraulic Cartridge	—	—	Hydraulic Cartridge
<b>Spring</b>	Coil	Coil	Coil	Coil	Coil	Coil	Air	Air	Air	Air	Air	Coil
<b>Adjustment</b>	RL, P	L, P	L, P	P	L, P	P	A, R, RL	A, R, L, C	A, RL	A, L	A, L	L, P (easy preload)
<b>Travel</b>	80, 100 mm	80 / 100 mm	80 / 100 mm	80 / 100 mm	26" / 24" : 80 / 50 mm	26" / 24" / 20" : 80 / 50 / 50 mm	50, 65, 75 mm	50, 65, 75 mm	50, 60 mm	50, 60 mm	50, 60 mm	50, 60 mm
<b>Fork offset</b>	38mm	38mm	38mm	38mm	38mm	38mm	44mm	44mm	44mm	44mm	44mm	44mm
<b>Fork height (mm)</b>	460 / 480	460 / 480	460 / 480	460 / 480	26" / 24" : 460 / 399	26" / 24" / 20" : 460 / 399 / 373	460 / 470 / 485	460 / 470 / 485	460 / 470	460 / 470	460 / 470	460 / 470
<b>Brake Type</b>	Disc or D+V	Disc or D+V	Disc or D+V	D+V	D+V	D+V	Disc or D+V	Disc or D+V	Disc or D+V	Disc or D+V	Disc or D+V	Disc or D+V
<b>Disc Brake Mount</b>	Post	Post	Post	IS	IS	IS	IS	IS	IS	IS	IS	IS
<b>Recommended Max. Rotor Size in mm</b>	180	180	180	180	180	180	180	180	180	180	180	180
<b>Dynamo Bracket Mount</b>	—	—	—	—	—	—	no	no	no	no	no	no
<b>Cable Guide for Hub Dynamo</b>	—	—	—	—	—	—	Option	Option	Option	Option	Option	Option
<b>Roller Brake Mount</b>	—	—	—	—	—	—	no	no	no	no	no	no
<b>Weight (kgs) (w/steerer at 200mm)</b>	2.42	2.35	2.10	2.05	2.03 / 1.93	1.98 / 1.84 / 1.75	1.65	1.63	2.10	2.02	1.80	2.28
<b>Wheel size</b>	26"	26"	26"	26"	26" / 24"	26" / 24" / 20"	700C Only	700C Only	700C Only	700C Only	700C Only	700C Only
<b>Origin of Production</b>	China	China	China	China	China	China	Taiwan	Taiwan	Taiwan	Taiwan	Taiwan	China
<b>2014 VS 2013</b>	—	—	—	—	—	—	Up-grade	Up-grade	New	New	New	—
<b>Remarks</b>	New Decal	New Decal	New Decal	New Decal	New Decal	New Decal	New Remote Lockout Lever	New Remote Lockout Lever	New Remote Lockout Lever	New Remote Lockout Lever	New Remote Lockout Lever	New Remote Lockout Lever

A : Air , R : Rebound , C : Compression , F : Flow-Gate , RL : Remote Lockout , L : Lockout , P : Preload

Bike Category	Cross			Cross			Cross			Trekking / City		
	TNL	VITA ML	T	RL	NOVA ML	T	RL	NEON ML	T	RL	VERSE ML	T
<b>Steerer</b>	28.6 / 25.4mm Steel	28.6 / 25.4mm Steel	28.6 / 25.4mm Steel	28.6 / 25.4mm Steel	28.6 / 25.4mm Steel	28.6 / 25.4mm Steel	28.6 / 25.4mm Steel	28.6 / 25.4mm Steel	28.6 / 25.4mm Steel	28.6 / 25.4mm Steel	28.6 / 25.4mm Steel	28.6 / 25.4mm Steel
<b>1.5" Steerer (Straight or Taper)</b>	—	—	—	—	—	—	—	—	—	—	—	—
<b>Crown</b>	112mm Aluminum, ED Black	112mm Aluminum, ED Black	112mm Aluminum, ED Black	112mm Aluminum, ED Black	112mm Aluminum, ED Black	112mm Aluminum, ED Black	112mm Aluminum, ED Black	112mm Aluminum, ED Black	112mm Aluminum, ED Black	112mm Aluminum, ED Black	112mm Aluminum, ED Black	112mm Aluminum, ED Black
<b>Stanchion</b>	28.6 steel Ti color	28.6 steel Ti color	28.6 steel Ti color	28.6 Steel CP	28.6 Steel CP	28.6 Steel CP	25.4 Steel CP	25.4 Steel CP	25.4 Steel CP	28.6 Steel CP	28.6 Steel CP	28.6 Steel CP
<b>Lower</b>	Magnesium 9mm Open Dropout	Magnesium 9mm Open Dropout	Magnesium 9mm Open Dropout	Aluminum 9mm Open Dropout	Aluminum 9mm Open Dropout	Aluminum 9mm Open Dropout	Aluminum 9mm Open Dropout	Aluminum 9mm Open Dropout	Aluminum 9mm Open Dropout	Aluminum 9mm Open Dropout	Aluminum 9mm Open Dropout	Aluminum 9mm Open Dropout
<b>Feature</b>	Hydraulic Lock-Out	Mechanical Lock-Out	—	Hydraulic Remote Lock-Out	Mechanical Lock-Out	—	Hydraulic Remote Lock-Out	Mechanical Lock-Out	—	Hydraulic Remote Lock-Out	Mechanical Lock-Out	—
<b>Damper</b>	Hydraulic Cartridge	—	—	Hydraulic Cartridge	—	—	Hydraulic Cartridge	—	—	Hydraulic Cartridge	—	—
<b>Spring</b>	Coil	Coil	Coil	Coil	Coil	Coil	Coil	Coil	Coil	Coil	Coil	Coil
<b>Adjustment</b>	L, P (easy preload)	L, P (easy preload)	L, P (easy preload)	RL, P	L, P	P	RL, P	L, P	P	RL, P	L, P	P
<b>Travel</b>	50, 60 mm	50, 60 mm	50, 60 mm	50, 60 mm	50, 60 mm	50, 60 mm	700C : 50, 60 mm / 26" : 75 mm	700C : 44 mm / 26" : 38 mm	700C : 44 mm / 26" : 38 mm	700C : 450 / 460	40, 50 mm	40, 50 mm
<b>Fork offset</b>	44mm	44mm	44mm	44mm	44mm	44mm	44mm	44mm	44mm	44mm	44mm	44mm
<b>Fork height (mm)</b>	460 / 470	460 / 470	460 / 470	460 / 470	460 / 470	460 / 470	700C : 460 / 470 / 26" : 465	700C : 460 / 470 / 26" : 465	700C : 460 / 470 / 26" : 465	450 / 460	450 / 460	450 / 460
<b>Brake Type</b>	Disc or D+V	Disc or D+V	Disc or D+V	Disc or D+V	Disc or D+V	Disc or D+V	D+V	D+V	D+V	V-brake Only	V-brake Only	V-brake Only
<b>Disc Brake Mount</b>	IS	IS	IS	IS	IS	IS	IS	IS	IS	no	no	no
<b>Recommended Max. Rotor Size in mm</b>	180	180	180	180	180	180	160	160	160	NIL	NIL	NIL
<b>Dynamo Bracket Mount</b>	no	no	no	no	no	no	yes	yes	yes	no	no	no
<b>Cable Guide for Hub Dynamo</b>	Option	Option	Option	Option	Option	Option	Option	Option	Option	Option	Option	Option
<b>Roller Brake Mount</b>	no	no	no	no	no	no	no	no	no	no	no	no
<b>Weight (kgs) (w/steerer at 200mm)</b>	2.20	1.98	1.98	2.58	2.30	2.31	2.19	1.95	1.94	2.59	2.30	2.31
<b>Wheel size</b>	700C Only	700C Only	700C Only	700C Only	700C Only	700C Only	700C & 26"	700C & 26"	700C & 26"	700C Only	700C Only	700C Only
<b>Origin of Production</b>	China	China	China	China	China	China	China	China	China	China	China	China
<b>2014 VS 2013</b>	—	—	—	NEON PLS	—	—	—	—	—	—	—	—
<b>Remarks</b>	New model name											



# RST 2014 PRODUCT SPECIFICATION

A : Air • R : Rebound • C : Compression • F : Flow-Gate • RL : Remote Lockout • L : Lockout • P : Preload

Bike Category	Trekking / City				E-Bike							
	SOFI		URBAN		PULSE 29		PULSE 650B					
	RL	ML	T	RL	ML	T	Air-RL	Air-TNL	RL	TNL	Air-RL	Air-TNL
<b>Steerer</b>	28.6 / 25.4mm Steel	28.6 / 25.4mm Steel	28.6 / 25.4mm Steel	28.6 / 25.4mm Steel	28.6 / 25.4mm Steel	28.6 / 25.4mm Steel	28.6mm Steel	28.6mm Steel	28.6mm Steel	28.6mm Steel	28.6mm Steel	28.6mm Steel
<b>1.5" Steerer (Straight or Taper)</b>	—	—	—	—	—	—	—	—	—	—	—	—
<b>Crown</b>	112mm Aluminum ED Black	112mm Aluminum ED Black	112mm Aluminum ED Black	112mm Aluminum ED Black	112mm Aluminum ED Black	112mm Aluminum ED Black	130mm Aluminum, ED Black	130mm Aluminum, ED Black	130mm Aluminum, ED Black	130mm Aluminum ED Black	130mm Aluminum ED Black	130mm Aluminum ED Black
<b>Stanchion</b>	25.4 Steel CP	25.4 Steel CP	25.4 Steel CP	25.4 Steel CP	25.4 Steel CP	25.4 Steel CP	30 Steel Ti color	30 Steel Ti color	30 Steel Ti color	30 Steel Ti color	30 Steel Ti color	30 Steel Ti color
<b>Lower</b>	Aluminum 9mm Open Dropout	Aluminum 9mm Open Dropout	Aluminum 9mm Open Dropout	Aluminum 9mm Open Dropout	Aluminum 9mm Open Dropout	Aluminum 9mm Open Dropout	Aluminum 9mm Open Dropout	Aluminum 9mm Open Dropout	Aluminum 9mm Open Dropout	Aluminum 9mm Open Dropout	Aluminum 9mm Open Dropout	Aluminum 9mm Open Dropout
<b>Feature</b>	Hydraulic Remote Lock-Out	Mechanical Lock-Out	—	Mechanical Lock-Out	Hydraulic Remote Lock-Out	—	Hydraulic Lock-Out Air Spring	Hydraulic Lock-Out Air Spring	Hydraulic Lock-Out Air Spring	Hydraulic Lock-Out	Hydraulic Remote Lock-out, Air Spring	Hydraulic Lock-Out Air Spring
<b>Damper</b>	Hydraulic Cartridge	—	—	—	Hydraulic Cartridge	—	Hydraulic Cartridge	Hydraulic Cartridge	Hydraulic Cartridge	Hydraulic Cartridge	Hydraulic Cartridge	Hydraulic Cartridge
<b>Spring</b>	Coil	Coil	Coil	Coil	Coil	Coil	Air	Air	Coil	Coil	Air	Air
<b>Adjustment</b>	RL, P	L, P	P	L, P	RL, P	P	A, RL	A, L	RL, P	L, P	A, RL	A, L
<b>Travel</b>	700C: 40, 50 mm / 26": 50 mm	700C: 44 mm / 26": 38 mm	700C: 450 / 460 / 26": 450	40 mm	44 mm	450	50 mm	51 mm	460	50 mm	44 mm	445
<b>Fork offset</b>												
<b>Fork height (mm)</b>												
<b>Brake Type</b>		V-brake Only			Roller & Disc brake only, No V-brake available							
<b>Disc Brake Mount</b>		no	yes	IS			Post	Post	Post	Post	Post	Post
<b>Recommended Max. Rotor Size in mm</b>		NIL	Option	160			180	180	180	180	180	180
<b>Dynamo Bracket Mount</b>	yes	yes	yes	yes	yes	yes	—	—	—	—	—	—
<b>Cable Guide for Hub Dynamo</b>	Option	Option	Option	Option	Option	Option	—	—	—	—	—	—
<b>Roller Brake Mount</b>	no	no	no	yes	yes	yes	—	—	—	—	—	—
<b>Weight (kgs) (w/steerer at 200mm)</b>	2.32	2.06	2.07	1.86	2.15	1.87	2.91	2.83	2.92	2.84	2.82	2.75
<b>Wheel size</b>		700C & 26"		700C Only			29"	29"	29"	29"	29"	27.5"
<b>Origin of Production</b>		China		China			Taiwan	Taiwan	Taiwan	Taiwan	Taiwan	Taiwan
<b>2014 VS 2013</b>	—	—	—	—	—	—	New	New	New	New	New	New
<b>Remarks</b>												



# RST 2014 PRODUCT SPECIFICATION

A : Air • R : Rebound • C : Compression • F : Flow-Gate • RL : Remote Lockout • L : Lockout • P : Preload

Bike Category	SINGLE SHOCK						RIGID FORK					
	Model	SS-M6	SS-A7-T	SS-A7	SS-A6-T	SS-A6	SS-A4-T	SS-A4	SS-A2-100	SS-A2-75	RF-M7	RF-M6
Steerer		28.6mm 7050 Aluminum (200mm length min.)	28.6mm 7050 Aluminum (200mm length min.)	28.6mm 7050 Aluminum (200mm length min.)	28.6mm 7050 Aluminum (200mm length min.)	28.6mm 7050 Aluminum (200mm length min.)	28.6mm 7050 Aluminum (200mm length min.)	28.6mm 7050 Aluminum (200mm length min.)	28.6mm 7050 Aluminum (200mm length min.)	28.6mm 7050 Aluminum (200mm length min.)	28.6mm 7050 Aluminum	28.6mm 7050 Aluminum
1.5" Steerer (Straight or Taper)		—	—	—	—	—	—	—	—	—	—	—
Crown		—	—	—	—	—	—	—	—	—	—	—
Stanchion		—	—	—	—	—	—	—	—	—	—	—
Lower		Magnesium 9mm Open Dropout	Aluminum 9mm Open Dropout	Aluminum 9mm Open Dropout	Aluminum 9mm Open Dropout	Aluminum 9mm Open Dropout	Aluminum 9mm Open Dropout	Aluminum 9mm Open Dropout	Aluminum 9mm Open Dropout	Aluminum 9mm Open Dropout	Magnesium 9mm Open Dropout	Magnesium 9mm Open Dropout
Feature		Mag. blade	Alu. Blade Spring preload	Alu. Blade	Alu. Blade Spring preload	Alu. Blade	Alu. Blade Spring preload	Alu. Blade	Alu. Blade (straight) Dropout pitch 100mm	Alu. Blade (curve) Dropout pitch 75mm	Mag. Blade	Mag. Blade
Damper		—	—	—	—	—	—	—	—	—	Hydraulic Cartridge	—
Spring		Coil with bumper	Coil with bumper	Coil with bumper	Coil with bumper	Coil with bumper	Coil with bumper	Coil with bumper	Coil with bumper	Coil with bumper	—	—
Adjustment		—	P	—	P	—	—	—	—	—	—	—
Travel		35 mm	30 mm	35 mm	30 mm	35 mm	30 mm	35 mm	30 mm	30 mm	—	—
Fork offset		43	43	43	43	43	—	—	—	—	—	—
Fork height (mm)		435	460	455	440	435	415	410	355	355	408	373
Seal/Boot		Long Boot	Long Boot	Long Boot	Long Boot	Long Boot	Long Boot	Long Boot	Long Boot	Long Boot	—	—
Brake Type		Disc & V-brake	Disc or Disc & V-brake(Optional Roller Mount)	Disc or Disc & V-brake(Optional Roller Mount)	Disc or Disc & V-brake(Optional Roller Mount)	Disc or Disc & V-brake(Optional Roller Mount)	Disc & V-brake	Disc & V-brake	Disc & V-brake	Disc & V-brake	Disc & V-brake (Optional Roller Mount)	—
Disc Brake Mount		IS	IS	IS	IS	IS	IS	IS	IS	IS	IS	—
Recommended Max. Rotor Size in mm		160	180	180	180	180	160	160	160	160	—	—
Dynamo Bracket Mount		YES	YES	YES	YES	YES	YES	YES	—	—	YES	YES
Cable Guide for Hub Dynamo		YES	YES	YES	YES	YES	YES	YES	—	—	YES	YES
Roller Brake Mount		—	option	option	option	option	—	—	—	—	YES	YES
Weight (kgs) (w/steerer at 200mm)		1.18	1.60	1.60	1.52	1.52	1.45	1.45	1.32	1.28	0.83	0.75
Wheel size		26"	700C	700C	26"	26"	24"	24"	20"	20"	700C	26"
Origin of Production		Taiwan	Taiwan	Taiwan	Taiwan	Taiwan	Taiwan	Taiwan	Taiwan	Taiwan	Taiwan	Taiwan
2014 VS 2013		—	—	—	—	—	—	—	—	—	—	—
Remarks												

# RST GLOBALLY

# GLOBAL DISTRIBUTORS

## RST USA OFFICE

After-Sales Service, Marketing, W. America  
Contact: Michael Dunn  
Email: sales@rstusa.com

## RST S.CHINA HUIYANG, CHINA

Manufacturing (overseas)

## RST E.CHINA JIANGSU, CHINA

Manufacturing (domestic)

## RST HEADQUARTER, TAIPEI, TAIWAN

Product development, Global sales, Manufacturing  
Contact: James Hsu  
Email: rst@rst.com.tw

## RST EUROPE OFFICE, STUTTGART, GERMANY

After-Sales Service, Marketing, Europe sales  
Contact: Stephan Gudat  
Email: info@rst-europe.eu

## ARGENTINA

Cortés Kerstian  
Tel: 54-351-4939560  
Fax: 43-7242-497401  
mailto:rst@kerstian.com.ar

## AUSTRIA

Thalinger Lange GmbH  
Tel: 43-7252-497080  
Fax: 43-7242-497401  
mailto:rst@thalinger-lange.com

## AUSTRALIA

Award Bicycle Co. Ltd.  
Tel: 03-9586-8300  
Fax: 03-9586-8301  
mailto:rst@awardbikes.com

## BRAZIL

LM Bikes  
Tel: 55-31-3263-8100  
mailto:velesonaco@lmbike.com.br

## BENELUX

Cyclia Inc  
Tel: 31-2020-6154589  
Fax: 31-2020-6154589  
info@cyclia.nl

## CHILE

Andes Industrial Ltd.  
Tel: 56-2-718-1102  
Fax: 56-2-718-1130  
info@andesindustrial.cl

## COLOMBIA

Law Importaciones  
Tel: 57-471-3222  
marcatia@emp.com

## CENTER AMERICA

DISTRIBUCIONA M.B.S.R.L.  
Tel: 506-244-992777  
Fax: 506-445-6689  
info@supernova.com

## CZECH/SLOVAK REPUBLIC

Universal Agency s.r.o.  
Tel: 420-244-992777  
Fax: 420-244-992778  
pavl.fas@uvb.cz

## CANADA

Frontier Bicycle Sport Inc.  
Tel: 1-514-637-6511  
Fax: 1-514-637-7999  
denn@frontierbicycle.com

## CHINA

Southwest Power Co., Ltd.  
Tel: 86-512-8516-0098  
Fax: 86-512-8516-0100  
services@hspower.cn

## ESTONIA

Velo-Puh  
Tel: 372-8-555-577  
Fax: 372-8-556-708  
info@velopus.ee

## FRANCE

RST Paul Lange France SARL  
Tel: 03-88-932101  
Fax: 03-88-933432  
paul.behnia@paul-lange.de

## GERMANY

Paul Lange & Co.  
Tel: 49-711-258802  
Fax: 49-711-258805  
info@paul-lange.de

## GREECE

Nikos Maniatis S.A.  
Tel: 30-2610-898045  
Fax: 30-2610-960424  
amanhat@teanika.gr

## HUNGARY

VELOBIKI Kft.  
Tel: 36-1-455-8010  
Fax: 36-1-455-8018

## INDONESIA

PT BINTANG TAMAR  
Tel: 021-6305555  
Fax: 021-6305992  
bt@undebike.com

## ISRAEL

Ranufim  
Tel: 972-644-602123  
Fax: 972-63020091  
ranufim@gmail.com

## ITALY

Cicli Prom Components SPA  
Tel: 02-868-99633  
Fax: 02-868-198364  
info@ciprom.com

## JAPAN

AKI Corporation, Ltd.  
Tel: 81-32-481-9515  
Fax: 81-3-291-69117  
info@akworld.co.jp

## KOREA

MBS Corporation  
Tel: 82-52-285-9415  
Fax: 82-52-285-9419  
efama@efama.com

## MEXICO

VG COMPONENT  
Tel: 52-33-343-3942  
info@vgbikes.com

## NEW ZEALAND

Sheppard Industries, Ltd.  
Tel: 64-9-816-8770  
Fax: 64-9-815-5902  
office@sheppardind.co.nz

## NORWAY

Daler A/S  
Tel: 47-688-9950  
Fax: 47-688-9968  
support@leer.no

## PHILIPPINES

Comet Cycle Center  
Tel: 63-2-375-5590  
Fax: 63-2-375-5590  
comet@dstb.net

## POLAND

Velo Sp. z o.o.  
Tel: 48-32-223-8377  
Fax: 48-32-223-8380  
office@velo.com.pl

## PORTUGAL

Misak  
Tel: 351-234-425607  
Fax: 351-234-425608  
mailto:misak@misak.pt

## RUSSIA

Velomobots Co. Ltd.  
Tel: +7-095-558-0200  
Fax: +7-095-559-1458

## SWITZERLAND

Fuchs-moveva AG  
Tel: 41-848-66-06  
Fax: 41-848-66-09  
info@fuchs-moveva.ch

## SLOVENIA/CROATIA

CS-EUROTRADE d.o.o.  
Tel: 386-7-46402-500  
Fax: 386-7-492-049  
info@cs-eurotrade.com

## THAILAND

Asia International  
Business & Sales Co., Ltd.  
Tel: 66-2-487-78154  
Fax: 66-2-448-3150  
seema1@hsr.com

## TAIWAN

Chyuan Heng Yi Enterprise Co., Ltd.  
Tel: 886-4-2628-7719  
Fax: 886-4-2628-9711

## U.K.

Claud Butler  
Tel: +44 (0)1652 656000  
Fax: +44 (0)1652 656040  
rstuk@claudbutler.co.uk

## U.S.A.

Quality Bicycle Products  
Tel: 1-800-348-0004  
Fax: 1-800-348-0211  
sales@qbp.com

## VENEZUELA

Industria Metalika C.A.  
Tel: 58-212-3712460  
Fax: 58-212-3710960  
metalika@carv.net